



REPUBLIC OF THE PHILIPPINES

PHILIPPINE COAST GUARD

139 25th Street, South Harbor, Port Area, 1018 Manila

PHILIPPINE BIDDING DOCUMENTS

(As Harmonized with Development Partners)

SUPPLY, DELIVERY AND INSTALLATION OF ANCHOR CHAINS AND IT'S ASSOCIATED COMPONENTS INTENDED FOR TEN (10) MRRVs

Government of the Republic of the Philippines

**Sixth Edition
02 August 2021**

**Supply, Delivery and Installation of Anchor Chains and
it's Associated Components Intended for Ten (10) MRRVs**

Table of Contents

Glossary of Acronyms, Terms, and Abbreviations	3
Section I. Invitation to Bid.....	6
Section II. Instructions to Bidders.....	10
1. Scope of Bid	11
2. Funding Information.....	11
3. Bidding Requirements	11
4. Corrupt, Fraudulent, Collusive, and Coercive Practices	11
5. Eligible Bidders.....	12
6. Origin of Goods	12
7. Subcontracts	12
8. Pre-Bid Conference	12
9. Clarification and Amendment of Bidding Documents	12
10. Documents comprising the Bid: Eligibility and Technical Components	12
11. Documents comprising the Bid: Financial Component	13
12. Bid Prices	13
13. Bid and Payment Currencies	14
14. Bid Security	14
15. Sealing and Marking of Bids	14
16. Deadline for Submission of Bids	15
17. Opening and Preliminary Examination of Bids	15
18. Domestic Preference	15
19. Detailed Evaluation and Comparison of Bids	15
20. Post-Qualification	16
21. Signing of the Contract	16
Section III. Bid Data Sheet	17
Section IV. General Conditions of Contract	20
1. Scope of Contract	21
2. Advance Payment and Terms of Payment	21
3. Performance Security	21
4. Inspection and Tests	21
5. Warranty	22
6. Liability of the Supplier	22
Section V. Special Conditions of Contract	23
Section VI. Schedule of Requirements	29
Section VII. Technical Specifications	39
Section VIII. Checklist of Technical and Financial Documents	50

**Supply, Delivery and Installation of Anchor Chains and
it's Associated Components Intended for Ten (10) MRRVs**

Glossary of Acronyms, Terms, and Abbreviations

ABC – Approved Budget for the Contract.

BAC – Bids and Awards Committee.

Bid – A signed offer or proposal to undertake a contract submitted by a bidder in response to and in consonance with the requirements of the bidding documents. Also referred to as *Proposal* and *Tender*. (2016 revised IRR, Section 5[c])

Bidder – Refers to a contractor, manufacturer, supplier, distributor and/or consultant who submits a bid in response to the requirements of the Bidding Documents. (2016 revised IRR, Section 5[d])

Bidding Documents – The documents issued by the Procuring Entity as the bases for bids, furnishing all information necessary for a prospective bidder to prepare a bid for the Goods, Infrastructure Projects, and/or Consulting Services required by the Procuring Entity. (2016 revised IRR, Section 5[e])

BIR – Bureau of Internal Revenue.

BSP – Bangko Sentral ng Pilipinas.

Consulting Services – Refer to services for Infrastructure Projects and other types of projects or activities of the GOP requiring adequate external technical and professional expertise that are beyond the capability and/or capacity of the GOP to undertake such as, but not limited to: (i) advisory and review services; (ii) pre-investment or feasibility studies; (iii) design; (iv) construction supervision; (v) management and related services; and (vi) other technical services or special studies. (2016 revised IRR, Section 5[i])

CDA - Cooperative Development Authority.

Contract – Refers to the agreement entered into between the Procuring Entity and the Supplier or Manufacturer or Distributor or Service Provider for procurement of Goods and Services; Contractor for Procurement of Infrastructure Projects; or Consultant or Consulting Firm for Procurement of Consulting Services; as the case may be, as recorded in the Contract Form signed by the parties, including all attachments and appendices thereto and all documents incorporated by reference therein.

CIF – Cost Insurance and Freight.

CIP – Carriage and Insurance Paid.

CPI – Consumer Price Index.

Supply, Delivery and Installation of Anchor Chains and its Associated Components Intended for Ten (10) MRRVs

DDP – Refers to the quoted price of the Goods, which means “delivered duty paid.”

DTI – Department of Trade and Industry.

EXW – Ex works.

FCA – “Free Carrier” shipping point.

FOB – “Free on Board” shipping point.

Foreign-funded Procurement or Foreign-Assisted Project– Refers to procurement whose funding source is from a foreign government, foreign or international financing institution as specified in the Treaty or International or Executive Agreement. (2016 revised IRR, Section 5[b]).

Framework Agreement – Refers to a written agreement between a procuring entity and a supplier or service provider that identifies the terms and conditions, under which specific purchases, otherwise known as “Call-Offs,” are made for the duration of the agreement. It is in the nature of an option contract between the procuring entity and the bidder(s) granting the procuring entity the option to either place an order for any of the goods or services identified in the Framework Agreement List or not buy at all, within a minimum period of one (1) year to a maximum period of three (3) years. (GPPB Resolution No. 27-2019)

GFI – Government Financial Institution.

GOCC – Government-owned and/or –controlled corporation.

Goods – Refer to all items, supplies, materials and general support services, except Consulting Services and Infrastructure Projects, which may be needed in the transaction of public businesses or in the pursuit of any government undertaking, project or activity, whether in the nature of equipment, furniture, stationery, materials for construction, or personal property of any kind, including non-personal or contractual services such as the repair and maintenance of equipment and furniture, as well as trucking, hauling, janitorial, security, and related or analogous services, as well as procurement of materials and supplies provided by the Procuring Entity for such services. The term “related” or “analogous services” shall include, but is not limited to, lease or purchase of office space, media advertisements, health maintenance services, and other services essential to the operation of the Procuring Entity. (2016 revised IRR, Section 5[r])

GOP – Government of the Philippines.

GPPB – Government Procurement Policy Board.

INCOTERMS – International Commercial Terms.

Infrastructure Projects – Include the construction, improvement, rehabilitation, demolition, repair, restoration or maintenance of roads and bridges, railways, airports, seaports, communication facilities, civil works components of information technology projects, irrigation, flood control and drainage, water supply, sanitation, sewerage and solid waste management systems, shore protection, energy/power and electrification facilities, national

**Supply, Delivery and Installation of Anchor Chains and
it's Associated Components Intended for Ten (10) MRRVs**

buildings, school buildings, hospital buildings, and other related construction projects of the government. Also referred to as *civil works or works*. (2016 revised IRR, Section 5[u])

LGUs – Local Government Units.

NFCC – Net Financial Contracting Capacity.

NGA – National Government Agency.

PhilGEPS - Philippine Government Electronic Procurement System.

Procurement Project – refers to a specific or identified procurement covering goods, infrastructure project or consulting services. A Procurement Project shall be described, detailed, and scheduled in the Project Procurement Management Plan prepared by the agency which shall be consolidated in the procuring entity's Annual Procurement Plan. (GPPB Circular No. 06-2019 dated 17 July 2019)

PSA – Philippine Statistics Authority.

SEC – Securities and Exchange Commission.

SLCC – Single Largest Completed Contract.

Supplier – refers to a citizen, or any corporate body or commercial company duly organized and registered under the laws where it is established, habitually established in business and engaged in the manufacture or sale of the merchandise or performance of the general services covered by his bid. (Item 3.8 of GPPB Resolution No. 13-2019, dated 23 May 2019). Supplier as used in these Bidding Documents may likewise refer to a distributor, manufacturer, contractor, or consultant.

UN – United Nations.

**Supply, Delivery and Installation of Anchor Chains and
it's Associated Components Intended for Ten (10) MRRVs**

Section I. Invitation to Bid

INVITATION TO BID FOR THE SUPPLY, DELIVERY AND INSTALLATION OF ANCHOR CHAINS AND IT'S ASSOCIATED COMPONENTS INTENDED FOR TEN (10) MRRVs

1. The Philippine Coast Guard, through the General Appropriation Act of 2021, intends to apply the sum of **SEVEN MILLION EIGHT HUNDRED SIXTEEN THOUSAND ONE HUNDRED SEVENTY-THREE PESOS AND 33/100 (Php7,816, 173.33)**, being the Approved Budget for the Contract (ABC), to payments under the contract for the **Supply, Delivery and Installation of Anchor Chains and it's Associated Components Intended for Ten (10) MRRVs**. Bids received in excess of the ABC shall be automatically rejected at bid opening.
2. The Philippine Coast Guard now invites bids for the Supply, Delivery and Installation of Anchor Chains and it's Associated Components Intended for Ten (10) MRRVs. Delivery of the Goods is required within **Ninety (90) calendar days** from the date of receipt by the winning supplier of the Notice to Proceed (NTP). Bidders should have been completed, within five (5) years from the date of submission and receipt of bids, a contract similar to the Project. The description of an eligible bidder is contained in the Bidding Documents, particularly, in Section II. Instructions to Bidders.
3. Bidding will be conducted through open competitive bidding procedures using a non-discretionary "pass/fail" criterion as specified in the 2016 Revised Implementing Rules and Regulations (IRR) of Republic Act (RA) 9184, otherwise known as the "Government Procurement Reform Act".

Bidding is restricted to Filipino citizens/sole proprietorships, partnerships, or organizations with at least sixty percent (60%) interest or outstanding capital stock belonging to citizens of the Philippines, and to citizens or organizations of a country the laws or regulations of which grant similar rights or privileges to Filipino citizens, pursuant to RA 5183.

4. Interested bidders may obtain further information from the Coast Guard Procurement Service and inspect the Bidding Documents at the address given below from Monday to Friday during office hours, 8:00 AM to 5:00 PM, except non-working days (i.e. Saturday and Sunday), legal holiday, or special non-working holiday, or other nonworking days duly declared by the President, Governor, Mayor or other Government Official authorized to make such declaration.
5. A complete set of Bidding Documents may be acquired by interested Bidders on **02 August 2021 to 23 August 2021** from the address below and upon payment of the applicable fee for the Bidding Documents, pursuant to the latest Guidelines issued by the GPPB, in the amount of **Ten Thousand Pesos (Php 10,000.00)**.

It may also be downloaded free of charge from the website of the Philippine Government Electronic Procurement System (PhilGEPS) and the website of the

**Supply, Delivery and Installation of Anchor Chains and
it's Associated Components Intended for Ten (10) MRRVs**

Philippine Coast Guard (PCG), provided that Bidders shall pay the applicable fee for the Bidding Documents not later than the submission of their bids.

6. The Philippine Coast Guard will hold a Pre-Bid Conference on **10 August 2021, 09:00 A.M.** at the PCG Conference Room, National Headquarters Philippine Coast Guard, 139 25th Street, Port Area, South Harbor, Manila, which shall be open to prospective bidders.
7. Bids must be duly received by the BAC Secretariat through manual submission at the address indicated below on or before **23 August 2021, 09:00 A.M.** Late bids shall not be accepted.
8. All Bids must be accompanied by a bid security in any of the acceptable forms and in the amount stated in **ITB** Clause 14.
9. Bid opening be on **23 August 2021, 09:00 A.M. onwards** at the Philippine Coast Guard Conference Room, 2F Admin Building, 139 25th Street, Port Area, Manila 1018. Bids will be opened in the presence of the bidders' representatives who choose to attend at the address below.
10. The Bids and Awards Committee (BAC) shall use a non-discretionary and non-discriminatory measure based on sheer luck or chance, which is "DRAW LOTS," in the event that two or more bidders have been post-qualified and determined as the bidder having the Lowest Calculated Responsive Bid (LCRB) to determine the final LCRB, based on the following procedures:
 - a) In alphabetical order, the bidders shall pick one rolled paper.
 - b) The lucky bidder who would pick the paper with a "CONGRATULATIONS" remark shall be declared as the final bidder having the LCRB and recommended for award of the contract.
11. The Philippine Coast Guard reserves the right to reject any and all bids, declare a failure of bidding, or not award the contract at any time prior to contract award in accordance with Section 35.6 and 41 of RA 9184 and its IRR, without thereby incurring any liability to the affected bidder or bidders.
12. For further information, please refer to:

CDR ARGIE LYN P MAHINAY PCG
Commander, Coast Guard Procurement Service
Coast Guard Procurement Service
Headquarters Philippine Coast Guard
139 25th Street, Port Area, South Harbor, Manila
Contact Number: (02) 527-8481 loc 6281/ 6282
Procurement@coastguard.gov.ph
Proc@coastguard.gov.ph
13. You may visit the following websites:

**Supply, Delivery and Installation of Anchor Chains and
it's Associated Components Intended for Ten (10) MRRVs**

For downloading of Bidding Documents: www.philgeps.gov.ph and
www.coastguard.gov.ph

[02 August 2021]

RADM ROLANDO LIZOR N PUNZALAN JR PCG
Chairman, Bids and Awards Committee

**Supply, Delivery and Installation of Anchor Chains and
it's Associated Components Intended for Ten (10) MRRVs**



Section II. Instructions to Bidders

Supply, Delivery and Installation of Anchor Chains and it's Associated Components Intended for Ten (10) MRRVs

1. Scope of Bid

- 1.1. The Procuring Entity, Philippine Coast Guard wishes to receive Bids for the Supply, Delivery and Installation of Anchor Chains and it's Associated Components Intended for Ten (10) MRRVs with identification number **IB-2021-025**.
- 1.2. The Supply, Delivery and Installation of Anchor Chains and it's Associated Components Intended for Ten (10) MRRVs is composed one (1) lot, the details of which are described Section VII (Technical Specifications) of this Bidding Documents.

2. Funding Information

- 2.1. The Government of the Philippines (GOP) through the General Appropriations Act (GAA) for CY 2021 in the amount of **SEVEN MILLION EIGHT HUNDRED SIXTEEN THOUSAND ONE HUNDRED SEVENTY-THREE PESOS AND 33/100 (Php7,816, 173.33)** as the Approved Budget for the Contract (ABC).
- 2.2. The source of funding is the General Appropriations Act.

3. Bidding Requirements

The Bidding for the Project shall be governed by all the provisions of RA No. 9184 and its 2016 revised IRR, including its Generic Procurement Manuals and associated policies, rules and regulations as the primary source thereof, while the herein clauses shall serve as the secondary source thereof.

Any amendments made to the IRR and other GPPB issuances shall be applicable only to the ongoing posting, advertisement, or **IB** by the BAC through the issuance of a supplemental or bid bulletin.

The Bidder, by the act of submitting its Bid, shall be deemed to have verified and accepted the general requirements of this Project, including other factors that may affect the cost, duration and execution or implementation of the contract, project, or work and examine all instructions, forms, terms, and project requirements in the Bidding Documents.

4. Corrupt, Fraudulent, Collusive, and Coercive Practices

The Procuring Entity, as well as the Bidders and Suppliers, shall observe the highest standard of ethics during the procurement and execution of the contract. They or through an agent shall not engage in corrupt, fraudulent, collusive, coercive, and obstructive practices defined under Annex "I" of the 2016 revised IRR of RA No. 9184 or other integrity violations in competing for the Project.

Supply, Delivery and Installation of Anchor Chains and it's Associated Components Intended for Ten (10) MRRVs

5. Eligible Bidders

- 5.1. Only Bids of Bidders found to be legally, technically, and financially capable will be evaluated.
- 5.2. Foreign ownership limited to those allowed under the rules may participate in this Project.
- 5.3. Pursuant to Section 23.4.1.3 of the 2016 revised IRR of RA No.9184, the Bidder shall have an SLCC that is at least one (1) contract similar to the Project the value of which, adjusted to current prices using the PSA's CPI, must be at least equivalent to equivalent to at least twenty-five percent (25%) of the ABC or not less than the amount of One Million Nine Hundred Fifty-Four Thousand Forty-Three Pesos and 33/100 (PhP1,954,043.33).
- 5.4. The Bidders shall comply with the eligibility criteria under Section 23.4.1 of the 2016 IRR of RA No. 9184.

6. Origin of Goods

There is no restriction on the origin of goods other than those prohibited by a decision of the UN Security Council taken under Chapter VII of the Charter of the UN, subject to Domestic Preference requirements under **ITB** Clause 18.

7. Subcontracts

- 7.1. The Bidder may subcontract portions of the Project to the extent allowed by the Procuring Entity as stated herein, but in no case more than twenty percent (20%) of the Project.

8. Pre-Bid Conference

The Procuring Entity will hold a pre-bid conference for this Project on **10 August 2021**, 09:00 A.M at its physical address at the Philippine Coast Guard Conference Room, 2F Admin Building, 139 25th Street, Port Area, Manila 1018 as indicated in paragraph 6 of the **IB**.

9. Clarification and Amendment of Bidding Documents

Prospective bidders may request for clarification on and/or interpretation of any part of the Bidding Documents. Such requests must be in writing and received by the Procuring Entity, either at its given address or through electronic mail indicated in the **IB**, at least ten (10) calendar days before the deadline set for the submission and receipt of Bids.

10. Documents comprising the Bid: Eligibility and Technical Components

Supply, Delivery and Installation of Anchor Chains and it's Associated Components Intended for Ten (10) MRRVs

- 10.1. The first envelope shall contain the eligibility and technical documents of the Bid as specified in **Section VIII (Checklist of Technical and Financial Documents)**.
- 10.2. The Bidder's SLCC as indicated in **ITB** Clause 5.3 should have been completed within *five (5) years* prior to the deadline for the submission and receipt of bids.
- 10.3. If the eligibility requirements or statements, the bids, and all other documents for submission to the BAC are in foreign language other than English, it must be accompanied by a translation in English, which shall be authenticated by the appropriate Philippine foreign service establishment, post, or the equivalent office having jurisdiction over the foreign bidder's affairs in the Philippines. Similar to the required authentication above, for Contracting Parties to the Apostille Convention, only the translated documents shall be authenticated through an apostille pursuant to GPPB Resolution No. 13-2019 dated 23 May 2019. The English translation shall govern, for purposes of interpretation of the bid.

11. Documents comprising the Bid: Financial Component

- 11.1. The second bid envelope shall contain the financial documents for the Bid as specified in **Section VIII (Checklist of Technical and Financial Documents)**.
- 11.2. If the Bidder claims preference as a Domestic Bidder or Domestic Entity, a certification issued by DTI shall be provided by the Bidder in accordance with Section 43.1.3 of the 2016 revised IRR of RA No. 9184.
- 11.3. Any bid exceeding the ABC indicated in paragraph 1 of the **IB** shall not be accepted.
- 11.4. For Foreign-funded Procurement, a ceiling may be applied to bid prices provided the conditions are met under Section 31.2 of the 2016 revised IRR of RA No. 9184.

12. Bid Prices

- 12.1. Prices indicated on the Price Schedule shall be entered separately in the following manner:
 - a. For Goods offered from within the Procuring Entity's country:
 - i. The price of the Goods quoted EXW (ex-works, ex-factory, ex-warehouse, ex-showroom, or off-the-shelf, as applicable);
 - ii. The cost of all customs duties and sales and other taxes already paid or payable;

Supply, Delivery and Installation of Anchor Chains and it's Associated Components Intended for Ten (10) MRRVs

- iii. The cost of transportation, insurance, and other costs incidental to delivery of the Goods to their final destination; and
 - iv. The price of other (incidental) services, if any, listed in e.
- b. For Goods offered from abroad:
- i. Unless otherwise stated in the **BDS**, the price of the Goods shall be quoted delivered duty paid (DDP) with the place of destination in the Philippines as specified in the **BDS**. In quoting the price, the Bidder shall be free to use transportation through carriers registered in any eligible country. Similarly, the Bidder may obtain insurance services from any eligible source country.
 - ii. The price of other (incidental) services, if any, as listed in **Section VII (Technical Specifications)**.

13. Bid and Payment Currencies

- 13.1. For Goods that the Bidder will supply from outside the Philippines, the bid prices may be quoted in the local currency or tradeable currency accepted by the BSP at the discretion of the Bidder. However, for purposes of bid evaluation, Bids denominated in foreign currencies, shall be converted to Philippine currency based on the exchange rate as published in the BSP reference rate bulletin on the day of the bid opening.
- 13.2. Payment of the contract price shall be made in Philippine Pesos.

14. Bid Security

- 14.1. The Bidder shall submit a Bid Securing Declaration or any form of Bid Security in the amount indicated in the **BDS**, which shall be not less than the percentage of the ABC in accordance with the schedule in the **BDS**.
- 14.2. The Bid and bid security shall be valid until one hundred twenty (120) calendar days from the date of the opening of bid. Any Bid not accompanied by an acceptable bid security shall be rejected by the Procuring Entity as non-responsive.

15. Sealing and Marking of Bids

Each Bidder shall submit one copy of the first and second components of its Bid.

The Procuring Entity may request additional hard copies and/or electronic copies of the Bid. However, failure of the Bidders to comply with the said request shall not be a ground for disqualification.

If the Procuring Entity allows the submission of bids through online submission or any other electronic means, the Bidder shall submit an electronic copy of its Bid,

Supply, Delivery and Installation of Anchor Chains and it's Associated Components Intended for Ten (10) MRRVs

which must be digitally signed. An electronic copy that cannot be opened or is corrupted shall be considered non-responsive and, thus, automatically disqualified.

16. Deadline for Submission of Bids

- 16.1. The Bidders shall submit on the specified date and time and either at its physical address or through online submission as indicated in paragraph 7 of the **IB**.

17. Opening and Preliminary Examination of Bids

- 17.1. The BAC shall open the Bids in public at the time, on the date, and at the place specified in paragraph 9 of the **IB**. The Bidders' representatives who are present shall sign a register evidencing their attendance. In case videoconferencing, webcasting or other similar technologies will be used, attendance of participants shall likewise be recorded by the BAC Secretariat.

In case the Bids cannot be opened as scheduled due to justifiable reasons, the rescheduling requirements under Section 29 of the 2016 revised IRR of RA No. 9184 shall prevail.

- 17.2. The preliminary examination of bids shall be governed by Section 30 of the 2016 revised IRR of RA No. 9184.

18. Domestic Preference

- 18.1. The Procuring Entity will grant a margin of preference for the purpose of comparison of Bids in accordance with Section 43.1.2 of the 2016 revised IRR of RA No. 9184.

19. Detailed Evaluation and Comparison of Bids

- 19.1. The Procuring BAC shall immediately conduct a detailed evaluation of all Bids rated "*passed*," using non-discretionary pass/fail criteria. The BAC shall consider the conditions in the evaluation of Bids under Section 32.2 of the 2016 revised IRR of RA No. 9184.
- 19.2. If the Project allows partial bids, bidders may submit a proposal on any of the lots or items, and evaluation will be undertaken on a per lot or item basis, as the case maybe. In this case, the Bid Security as required by **ITB** Clause 15 shall be submitted for each lot or item separately.
- 19.3. The descriptions of the lots or items shall be indicated in **Section VII (Technical Specifications)**, although the ABCs of these lots or items are indicated in the **BDS** for purposes of the NFCC computation pursuant to Section 23.4.2.6 of the 2016 revised IRR of RA No. 9184. The NFCC must be sufficient for the total of the ABCs for all the lots or items participated in by the prospective Bidder.

Supply, Delivery and Installation of Anchor Chains and it's Associated Components Intended for Ten (10) MRRVs

- 19.4. The Project shall be awarded as follows One Project having several items that shall be awarded as one contract.
- 19.5. Except for bidders submitting a committed Line of Credit from a Universal or Commercial Bank in lieu of its NFCC computation, all Bids must include the NFCC computation pursuant to Section 23.4.1.4 of the 2016 revised IRR of RA No. 9184, which must be sufficient for the total of the ABCs for all the lots or items participated in by the prospective Bidder. For bidders submitting the committed Line of Credit, it must be at least equal to ten percent (10%) of the ABCs for all the lots or items participated in by the prospective Bidder.

20. Post-Qualification

- 20.2. Within a non-extendible period of five (5) calendar days from receipt by the Bidder of the notice from the BAC that it submitted the Lowest Calculated Bid, the Bidder shall submit its latest income and business tax returns filed and paid through the BIR Electronic Filing and Payment System (eFPS) and other appropriate licenses and permits required by law and stated in the **BDS**.

21. Signing of the Contract

- 21.1. The documents required in Section 37.2 of the 2016 revised IRR of RA No. 9184 shall form part of the Contract. Additional Contract documents are indicated in the **BDS**.

**Supply, Delivery and Installation of Anchor Chains and
it's Associated Components Intended for Ten (10) MRRVs**



Section III. Bid Data Sheet

**Supply, Delivery and Installation of Anchor Chains and
it's Associated Components Intended for Ten (10) MRRVs**

Bid Data Sheet

ITB Clause	
5.3	For this purpose, contracts similar to the Project shall be: <ul style="list-style-type: none"> a. Any supply, delivery and installation of anchor, anchor chains and other related components. b. Completed within five (5) years prior to the deadline for the submission and receipt of bids.
7.1	No portion of the contract shall be sub-contracted.
12	The price of the Goods shall be quoted DDP Aboard Coast Guard Surface Support Force, Pier 13, South Harbor, Port Area, Manila.
14.1	The bid security shall be in the form of a Bid Securing Declaration, or any of the following forms and amounts: <ul style="list-style-type: none"> a. The amount of not less than two percent (2%) of the ABC or at least the amount of One Hundred Fifty-Six Thousand Three Hundred Twenty-Three Pesos and 47/100 (PhP 156,323.47), if bid security is in cash, cashier's/manager's check, bank draft/guarantee or irrevocable letter of credit; or b. The amount of not less than five percent (5%) of the ABC of at least the amount of Three Hundred Ninety Thousand Eight Hundred Eight Pesos and 67/100 (PhP 390,808.67), if bid security is in Surety Bond.
19.3	Partial bid is not allowed. The goods are grouped in a single lot and the lot shall not be divided into sub-lots for the purpose of bidding, evaluation, and contract award. The Project shall be awarded as One Project having several items that shall be awarded as one contract.
20.2	No additional requirements. The bidder having the Lowest Calculated Bid (LCB) or Single Calculated Bid (SCB) shall submit within a non-extendible period of five (5) calendar days from the BAC Notice as the LCB/SCB, the following: <ol style="list-style-type: none"> 1. In case the bidder has just submitted the Class "A" Legal eligibility requirements and Audited Financial Statement (AFS), a valid PhilGEPS Registration Certificate; 2. Latest income and business tax returns filed and paid through the BIR Electronic Filing and Payment System (eFPS); <p align="center">In accordance with Executive Order (E.O.) No. 398, Revenue Regulation</p>

**Supply, Delivery and Installation of Anchor Chains and
it's Associated Components Intended for Ten (10) MRRVs**

	<p>(R.R.) No. 03-2005 and Revenue Memorandum Circular (RMC) 16 – 2005, the above-mentioned tax returns shall refer to the following:</p> <p>2.1. Latest Income Tax Return (ITR) shall be the ITR for the preceding year, whether calendar or fiscal, and</p> <p>2.2. Latest Business Tax Returns shall refer to the Value Added Tax (VAT) or Percentage Tax filed and paid covering the previous six (6) months before the date of Submission, Receipt, Opening & Preliminary Examination of Bids.</p>
21.2	<p>In addition to the submission of a Performance Securing Declaration or any of the allowable forms of Performance Security provided under Section 39.2 of the 2016 Revised Implementing Rules and Regulations (IRR) of Republic Act (R.A.) No. 9184, the bidder having the Lowest/Single Calculated Responsive Bid shall submit a Certificate of No Pending Case within ten (10) calendar days from receipt of the Notice of Award (NOA).</p>

**Supply, Delivery and Installation of Anchor Chains and
it's Associated Components Intended for Ten (10) MRRVs**



Section IV. General Conditions of Contract

Supply, Delivery and Installation of Anchor Chains and its Associated Components Intended for Ten (10) MRRVs

1. Scope of Contract

This Contract shall include all such items, although not specifically mentioned, that can be reasonably inferred as being required for its completion as if such items were expressly mentioned herein. All the provisions of RA No. 9184 and its 2016 revised IRR, including the Generic Procurement Manual, and associated issuances, constitute the primary source for the terms and conditions of the Contract, and thus, applicable in contract implementation. Herein clauses shall serve as the secondary source for the terms and conditions of the Contract.

This is without prejudice to Sections 74.1 and 74.2 of the 2016 revised IRR of RA No. 9184 allowing the GPPB to amend the IRR, which shall be applied to all procurement activities, the advertisement, posting, or invitation of which were issued after the effectivity of the said amendment.

Additional requirements for the completion of this Contract shall be provided in the **Special Conditions of Contract (SCC)**.

2. Advance Payment and Terms of Payment

2.1. Advance payment of the contract amount is provided under Annex “D” of the revised 2016 IRR of RA No. 9184.

2.2. The Procuring Entity is allowed to determine the terms of payment on the partial or staggered delivery of the Goods procured, provided such partial payment shall correspond to the value of the goods delivered and accepted in accordance with prevailing accounting and auditing rules and regulations. The terms of payment are indicated in the **SCC**.

3. Performance Security

Within ten (10) calendar days from receipt of the Notice of Award by the Bidder from the Procuring Entity but in no case later than prior to the signing of the Contract by both parties, the successful Bidder shall furnish the performance security in any of the forms prescribed in Section 39 of the 2016 revised IRR of RA No. 9184.

4. Inspection and Tests

The Procuring Entity or its representative shall have the right to inspect and/or to test the Goods to confirm their conformity to the Project. In addition to tests in the **SCC**, **Section IV (Technical Specifications)** shall specify what inspections and/or tests the Procuring Entity requires, and where they are to be conducted. The Procuring Entity shall notify the Supplier in writing, in a timely manner, of the identity of any representatives retained for these purposes.

All reasonable facilities and assistance for the inspection and testing of Goods, including access to drawings and production data, shall be provided by the Supplier to the authorized inspectors at no charge to the Procuring Entity.

**Supply, Delivery and Installation of Anchor Chains and
it's Associated Components Intended for Ten (10) MRRVs**

5. Warranty

- 6.1. In order to assure that manufacturing defects shall be corrected by the Supplier, a warranty shall be required from the Supplier as provided under Section 62.1 of the 2016 revised IRR of RA No. 9184.
- 6.2. The Procuring Entity shall promptly notify the Supplier in writing of any claims arising under this warranty. Upon receipt of such notice, the Supplier shall, repair or replace the defective Goods or parts thereof without cost to the Procuring Entity, pursuant to the Generic Procurement Manual.

6. Liability of the Supplier

The Supplier's liability under this Contract shall be as provided by the laws of the Republic of the Philippines.

If the Supplier is a joint venture, all partners to the joint venture shall be jointly and severally liable to the Procuring Entity.

**Supply, Delivery and Installation of Anchor Chains and
it's Associated Components Intended for Ten (10) MRRVs**



Section V. Special Conditions of Contract

**Supply, Delivery and Installation of Anchor Chains and
it's Associated Components Intended for Ten (10) MRRVs**

Special Conditions of Contract

GCC Clause	
1	<p>Delivery and Documents –</p> <p>For purposes of the Contract, “EXW,” “FOB,” “FCA,” “CIF,” “CIP,” “DDP” and other trade terms used to describe the obligations of the parties shall have the meanings assigned to them by the current edition of INCOTERMS published by the International Chamber of Commerce, Paris. The Delivery terms of this Contract shall be as follows:</p> <p>For Goods supplied from abroad:</p> <p>Delivery terms applicable to the Contract are DPP delivered Aboard Coast Guard Surface Support Force, Pier 13, South Harbor, Port Area, Manila. In accordance with INCOTERMS.</p> <p>For Goods supplied from within the Philippines:</p> <p>The delivery terms applicable to this Contract are DPP delivered Aboard Coast Guard Surface Support Force, Pier 13, South Harbor, Port Area, Manila. Risk and title will pass from the Supplier to the Procuring Entity upon receipt and final acceptance of the Goods at their final destination.</p> <p>Delivery of the Goods shall be made by the Supplier in accordance with the terms specified in Section VI (Schedule of Requirements).</p> <p>For purposes of this Clause the Procuring Entity’s Representative at the Project Site is:</p> <p>CG CAPT PAOLO Z ABEJUELA (Msc) Commander, Ships and Aircraft Engineering, CG-10 Philippine Coast Guard YMCA Building, Ermita Manila Email: cg10@coastguard.gov.ph Contact Number: (+63)917-84-250-5038</p> <p>Incidental Services –</p> <p>The Supplier is required to provide all of the following services, including additional services, if any, specified in Section VI. Schedule of Requirements:</p>

**Supply, Delivery and Installation of Anchor Chains and
it's Associated Components Intended for Ten (10) MRRVs**

- a. performance or supervision of on-site assembly and/or start-up of the supplied Goods;
- b. furnishing of tools required for assembly and/or maintenance of the supplied Goods;
- c. furnishing of a detailed operations and maintenance manual for each appropriate unit of the supplied Goods; and
- d. performance or supervision or maintenance and/or repair of the supplied Goods, for a period of time agreed by the parties, provided that this service shall not relieve the Supplier of any warranty obligations under this Contract; and

The Contract price for the Goods shall include the prices charged by the Supplier for incidental services and shall not exceed the prevailing rates charged to other parties by the Supplier for similar services.

Spare Parts –

The Supplier is required to provide all of the following materials, notifications, and information pertaining to goods manufactured or distributed by the Supplier:

- a. such goods as the Procuring Entity may elect to purchase from the Supplier, provided that this election shall not relieve the Supplier of any warranty obligations under this Contract; and
- b. in the event of termination of production of the goods:
 - i. advance notification to the Procuring Entity of the pending termination, in sufficient time to permit the Procuring Entity to procure needed requirements; and
 - ii. following such termination, furnishing at no cost to the Procuring Entity, the blueprints, drawings, and specifications of the goods/items, if requested.

The goods required are listed in **Section VI (Schedule of Requirements)** and the cost thereof are included in the contract price.

The Supplier shall carry sufficient inventories to assure ex-stock supply of consumable items for the Goods for a period of five (5) years.

Goods and other related components shall be supplied as promptly as possible, but in any case, within one (1) month of placing the order.

Packaging –

The Supplier shall provide such packaging of the Goods as is required to prevent their damage or deterioration during transit to their final destination, as indicated in this Contract. The packaging shall be sufficient to withstand, without limitation, rough handling during transit and exposure to extreme temperatures, salt and precipitation during transit, and open storage. Packaging case size and

**Supply, Delivery and Installation of Anchor Chains and
it's Associated Components Intended for Ten (10) MRRVs**

	<p>weights shall take into consideration, where appropriate, the remoteness of the Goods' final destination and the absence of heavy handling facilities at all points in transit.</p> <p>The packaging, marking, and documentation within and outside the packages shall comply strictly with such special requirements as shall be expressly provided for in the Contract, including additional requirements, if any, specified below, and in any subsequent instructions ordered by the Procuring Entity.</p> <p>The outer packaging must be clearly marked on at least four (4) sides as follows:</p> <p>Name of the Procuring Entity Name of the Supplier Contract Description Final Destination Gross weight Any special lifting instructions Any special handling instructions Any relevant HAZCHEM classifications</p> <p>A packaging list identifying the contents and quantities of the package is to be placed on an accessible point of the outer packaging if practical. If not practical the packaging list is to be placed inside the outer packaging but outside the secondary packaging.</p> <p>Transportation –</p> <p>Where the Supplier is required under Contract to deliver the Goods CIF, CIP, or DDP, transport of the Goods to the port of destination or such other named place of destination in the Philippines, as shall be specified in this Contract, shall be arranged and paid for by the Supplier, and the cost thereof shall be included in the Contract Price.</p> <p>Where the Supplier is required under this Contract to transport the Goods to a specified place of destination within the Philippines, defined as the Project Site, transport to such place of destination in the Philippines, including insurance and storage, as shall be specified in this Contract, shall be arranged by the Supplier, and related costs shall be included in the contract price.</p> <p>Where the Supplier is required under Contract to deliver the Goods CIF, CIP or DDP, Goods are to be transported on carriers of Philippine registry. In the event that no carrier of Philippine registry is available, Goods may be shipped by a carrier which is not of Philippine registry provided that the Supplier obtains and presents to the Procuring Entity certification to this effect from the nearest Philippine consulate to the port of dispatch. In the event that carriers of Philippine registry are available but their schedule delays the Supplier in its performance of this Contract the period from when the Goods were first ready for shipment and the actual date of shipment the period of delay will be considered force majeure.</p>
--	--

**Supply, Delivery and Installation of Anchor Chains and
it's Associated Components Intended for Ten (10) MRRVs**

	<p>The Procuring Entity accepts no liability for the damage of Goods during transit other than those prescribed by INCOTERMS for DDP deliveries. In the case of Goods supplied from within the Philippines or supplied by domestic Suppliers risk and title will not be deemed to have passed to the Procuring Entity until their receipt and final acceptance at the final destination.</p> <p>Intellectual Property Rights –</p> <p>The Supplier shall indemnify the Procuring Entity against all third-party claims of infringement of patent, trademark, or industrial design rights arising from use of the Goods or any part thereof.</p>					
2.2	<p>The terms of payment shall be as follows:</p> <ul style="list-style-type: none">➤ No advance payment is allowed.➤ Payment shall be made upon delivery of every items ordered upon submission of the invoices describing the goods delivered, subject to accounting and auditing rules and procedures➤ Payment shall be provided based on the following schedule: <table border="1"><tr><td><i>First (1st) Option:</i></td></tr><tr><td>99% of the costs of the items delivered subject to the Philippine Coast Guard’s acceptance [Issuance of the Inspection and Acceptance Report (IAR)] in writing.</td></tr><tr><td>1% Retention of the items delivered to be paid after one (1) year from the formal acceptance (issuance of the IAR), if and when no patent and latent defects are noted (issuance of a Certificate of No Patent and Latent Defects).</td></tr></table> <p style="text-align: center;">OR</p> <table border="1"><tr><td><i>Second (2nd) Option:</i></td></tr><tr><td>100% of the costs of the items delivered provided that the goods supplied are free from patent and latent defects and all conditions imposed under the contract have been fully met; subject to the Philippine Coast Guard’s acceptance (issuance of the IAR) in writing of the items described in this Contract and upon submission of a Special Bank Guarantee equivalent to at least one percent (1%) of the total contract price valid for one (1) year from issuance of the IAR.</td></tr></table>	<i>First (1st) Option:</i>	99% of the costs of the items delivered subject to the Philippine Coast Guard’s acceptance [Issuance of the Inspection and Acceptance Report (IAR)] in writing.	1% Retention of the items delivered to be paid after one (1) year from the formal acceptance (issuance of the IAR), if and when no patent and latent defects are noted (issuance of a Certificate of No Patent and Latent Defects).	<i>Second (2nd) Option:</i>	100% of the costs of the items delivered provided that the goods supplied are free from patent and latent defects and all conditions imposed under the contract have been fully met; subject to the Philippine Coast Guard’s acceptance (issuance of the IAR) in writing of the items described in this Contract and upon submission of a Special Bank Guarantee equivalent to at least one percent (1%) of the total contract price valid for one (1) year from issuance of the IAR.
<i>First (1st) Option:</i>						
99% of the costs of the items delivered subject to the Philippine Coast Guard’s acceptance [Issuance of the Inspection and Acceptance Report (IAR)] in writing.						
1% Retention of the items delivered to be paid after one (1) year from the formal acceptance (issuance of the IAR), if and when no patent and latent defects are noted (issuance of a Certificate of No Patent and Latent Defects).						
<i>Second (2nd) Option:</i>						
100% of the costs of the items delivered provided that the goods supplied are free from patent and latent defects and all conditions imposed under the contract have been fully met; subject to the Philippine Coast Guard’s acceptance (issuance of the IAR) in writing of the items described in this Contract and upon submission of a Special Bank Guarantee equivalent to at least one percent (1%) of the total contract price valid for one (1) year from issuance of the IAR.						

**Supply, Delivery and Installation of Anchor Chains and
it's Associated Components Intended for Ten (10) MRRVs**

4	<p>The inspections and tests that will be conducted are as follows:</p> <ul style="list-style-type: none">● The inspection and test shall be conducted at the Coast Guard Surface Support Force, Pier 13, South Harbor, Port Area, Manila by the end-user and the Technical Inspection and Acceptance Committee (TIAC).● Only items in conformity with the required quantity and technical specifications shall be accepted.
---	---

**Supply, Delivery and Installation of Anchor Chains and
it's Associated Components Intended for Ten (10) MRRVs**



Section VI. Schedule of Requirements

The delivery schedule expressed as weeks/months stipulates hereafter a delivery date which is the date of delivery to the project site.

Description	QTY	UNIT	Delivered, Weeks/Months
A - FOR BRP TUBBATAHA (MRRV-4401)			The total number of days of delivery shall not exceed Ninety (90) calendar days after receipt of NTP
Labor components			
1. Mobilization, hauling/transport & installation of port and starboard side anchor chain.	1	Lot	
2. Repair, refurbishing and repainting of anchor house/lockers.	1	Lot	
3. Repair, refurbishing and re-padding of 2 sets of anchor windlass break pad.	2	Lot	
4. Test for satisfactory result.	1	Lot	
Material components:			
1. Supply and delivery of stud link anchor chain 17.50 millimeters (mm) x 137.5 meters (m) Materials: Grade 3 (for port and starboard side)	10	Shots	
2. Supply and delivery of Common link (C), End link (E), End shackle (1), Enlarged link (L), Swivel (S) Materials: Grade 3 (for port and starboard side)	1	Lot	
3. Bituminous paint solution, brushes, sand papers and other consumables.	1	Lot	

**Supply, Delivery and Installation of Anchor Chains and
it's Associated Components Intended for Ten (10) MRRVs**

B - FOR BRP MALABRIGO (MRRV-4402)		
Labor components		
1. Mobilization, hauling/transport & installation of port and starboard side anchor chain.	1	Lot
2. Repair, refurbishing and repainting of anchor house/lockers.	1	Lot
3. Repair, refurbishing and re-padding of 2 sets of anchor windlass break pad.	2	Lots
4. Test for satisfactory result.	1	Lot
Material components		
1. Supply and delivery of stud link anchor chain 17.50 millimeters (mm) x 137.5 meters (m) Materials: Grade 3 (for port and starboard side)	10	Shots
2. Supply and delivery of Common link (C), End link (E), End shackle (1), Enlarged link (L), Swivel (S) Materials: Grade 3 (for port and starboard side)	1	Lot
3. Bituminous paint solution, brushes, sand papers and other consumables.	1	Lot
C - FOR BRP MALAPASCUA (MRRV-4403)		
Labor components		
1. Mobilization, hauling/transport & installation of port and starboard side anchor chain.	1	Lot
2. Repair, refurbishing and repainting of anchor house/lockers.	1	Lot
3. Repair, refurbishing and re-padding of 2 sets of anchor windlass break pad.	2	Lots
4. Test for satisfactory result	1	Lot
Material components		
1. Supply and delivery of stud link anchor chain 17.50 millimeters (mm) x 137.5	10	Shots

**Supply, Delivery and Installation of Anchor Chains and
it's Associated Components Intended for Ten (10) MRRVs**

<p>meters (m)</p> <p>Materials: Grade 3 (for port and starboard side)</p>		
<p>2. Supply and delivery of Common link €, End link €, End shackle (1), Enlarged link (L), Swivel (S)</p> <p>Materials: Grade 3 (for port and starboard side)</p>	1	Lot
<p>3. Bituminous paint solution, brushes, sand papers and other consumables.</p>	1	Lot
D - FOR BRP CAPONES (MRRV-4404)		
Labor components		
<p>1. Mobilization, hauling/transport & installation of port and starboard side anchor chain.</p>	1	Lot
<p>2. Repair, refurbishing and repainting of anchor house/lockers.</p>	1	Lot
<p>3. Repair, refurbishing and re-padding of 2 sets of anchor windlass break pad.</p>	2	Lots
<p>4. Test for satisfactory result.</p>	1	Lot
Material components		
<p>1. Supply and delivery of stud link anchor chain 17.50 millimeters (mm) x 137.5 meters (m)</p> <p>Materials: Grade 3 (for port and starboard side)</p>	10	Shots
<p>2. Supply and delivery of Common link (C), End link (E), End shackle (1), Enlarged link (L), Swivel (S)</p> <p>Materials: Grade 3 (for port and starboard side)</p>	1	Lot
<p>3. Bituminous paint solution, brushes, sand papers and other consumables.</p>	1	Lot
<p>4. Stockless Anchor (315kg)</p>	1	Lot

**Supply, Delivery and Installation of Anchor Chains and
it's Associated Components Intended for Ten (10) MRRVs**

E - FOR BRP SULUAN (MRRV-4406)		
Labor component		
1. Mobilization, hauling/transport & installation of port and starboard side anchor chain.	1	Lot
2. Repair, refurbishing and repainting of anchor house/lockers.	1	Lot
3. Repair, refurbishing and re-padding of 2 sets of anchor windlass break pad.	2	Lots
4. Test for satisfactory result.	1	Lot
Material components		
1. Supply and delivery of stud link anchor chain 17.50 millimeters (mm) x 137.5 meters (m) Materials: Grade 3 (for port and starboard side)	10	Shots
2. Supply and delivery of Common link (C), End link (E), End shackle (1), Enlarged link (L), Swivel (S) Materials: Grade 3 (for port and starboard side)	1	Lot
3. Bituminous paint solution, brushes, sand papers and other consumables.	1	Lot
F - FOR BRP SINDANGAN (MRRV-4407)		
Labor components		
1. Mobilization, hauling/transport & installation of port and starboard side anchor chain.	1	Lot
2. Repair, refurbishing and repainting of anchor house/lockers.	1	Lot
3. Repair, refurbishing and re-padding of 2 sets of anchor windlass break pad.	2	Lot
4. Test for satisfactory result.	1	Lot
Material components:		
1. Supply and delivery of stud link anchor	10	Shot

**Supply, Delivery and Installation of Anchor Chains and
it's Associated Components Intended for Ten (10) MRRVs**

chain 17.50 millimeters (mm) x 137.5 meters (m) Materials: Grade 3 (for port and starboard side)		
2. Supply and delivery of Common link (C), End link (E), End shackle (1), Enlarged link (L), Swivel (S) Materials: Grade 3 (for port and starboard side)	1	Lot
3. Bituminous paint solution, brushes, sand papers and other consumables.	1	Lot
G - FOR BRP CAPE SAN AGUSTIN (MRRV-4408)		
Labor components		
1. Mobilization, hauling/transport & installation of port and starboard side anchor chain.	1	Lot
2. Repair, refurbishing and repainting of anchor house/lockers.	1	Lot
3. Repair, refurbishing and re-padding of 2 sets of anchor windlass break pad.	2	Lot
4. Test for satisfactory result.	1	Lot
Material components		
1. Supply and delivery of stud link anchor chain 17.50 millimeters (mm) x 137.5 meters (m) Materials: Grade 3 (for port and starboard side)	10	Shot
2. Supply and delivery of Common link (C), End link (E), End shackle (1), Enlarged link (L), Swivel (S) Materials: Grade 3 (for port and starboard side)	1	Lot
3. Bituminous paint solution, brushes, sand papers and other consumables.	1	Lot

**Supply, Delivery and Installation of Anchor Chains and
it's Associated Components Intended for Ten (10) MRRVs**

H - FOR BRP CABRA (MRRV-4409)		
Labor components		
1. Mobilization, hauling/transport & installation of port and starboard side anchor chain.	1	Lot
2. Repair, refurbishing and repainting of anchor house/lockers.	1	Lot
3. Repair, refurbishing and re-padding of 2 sets of anchor windlass break pad.	2	Lots
4. Test for satisfactory result.	1	Lot
Material components		
1. Supply and delivery of stud link anchor chain 17.50 millimeters (mm) x 137.5 meters (m) Materials: Grade 3 (for port and starboard side)	10	Shot
2. Supply and delivery of Common link (C), End link (E), End shackle (1), Enlarged link (L), Swivel (S) Materials: Grade 3 (for port and starboard side)	1	Lot
3. Bituminous paint solution, brushes, sand papers and other consumables.	1	Lot
I - FOR BRP BAGACAY (MRRV-4410)		
Labor components		
1. Mobilization, hauling/transport & installation of port and starboard side anchor chain.	1	Lot
2. Repair, refurbishing and repainting of anchor house/lockers.	1	Lot
3. Repair, refurbishing and re-padding of 2 sets of anchor windlass break pad.	2	Lots
4. Test for satisfactory result.	1	Lot

**Supply, Delivery and Installation of Anchor Chains and
it's Associated Components Intended for Ten (10) MRRVs**

Material components		
1. Supply and delivery of stud link anchor chain 17.50 millimeters (mm) x 137.5 meters (m) Materials: Grade 3 (for port and starboard side)	10	Shots
2. Supply and delivery of Common link (C), End link (E), End shackle (1), Enlarged link (L), Swivel (S) Materials: Grade 3 (for port and starboard side)	1	Lot
3. Bituminous paint solution, brushes, sand papers and other consumables.	1	Lot
J - FOR BRP CAPE ENGANO (MRRV-4411)		
Labor components		
1. Mobilization, hauling/transport & installation of port and starboard side anchor chain.	1	Lot
2. Repair, refurbishing and repainting of anchor house/lockers.	1	Lot
3. Repair, refurbishing and re-padding of 2 sets of anchor windlass break pad.	2	Lots
4. Test for satisfactory result.	1	Lot
Material components		
1. Supply and delivery of stud link anchor chain 17.50 millimeters (mm) x 137.5 meters (m) Materials: Grade 3 (for port and starboard side)	10	Shot
2. Supply and delivery of Common link (C), End link (E), End shackle (1), Enlarged link (L), Swivel (S) Materials: Grade 3 (for port and starboard side)	1	Lot
3. Bituminous paint solution, brushes, sand papers and other consumables.	1	Lot

**Supply, Delivery and Installation of Anchor Chains and
it's Associated Components Intended for Ten (10) MRRVs**

ITEM	UNIT	QUANTITY	TOTAL QUANTITY FOR ALL MRRVs (PORT AND STARBOARD SIDE) (X 20)
End link	pc	1	20
End shackle	pc	1	20
Enlarge link	pcs	2	40
Kenter shackle	pcs	2	40
Swivel	pc	1	20
Stud link	Meters	137.5	2,750

Dimensions and Specifications:

Stud link anchor chain

- 17.5 mm (diameter)
- 27.5 m per shot x 5 shots = 137.5 meters
- 137.5 m x 2 (port and starboard anchor chain) = 275 meters per MRRV
- 275 m x 10 (MRRV) = **2,750 meters**
- **Chain Link Size:** Outside Length (105 mm), Outside Width (63 mm)
- **Grade:** Grade 3 (Proof Load at least 179 kN), (Breaking Load at least 256 kN)
- **Paint:** Bituminous paint solutions

I. Anchor Chain

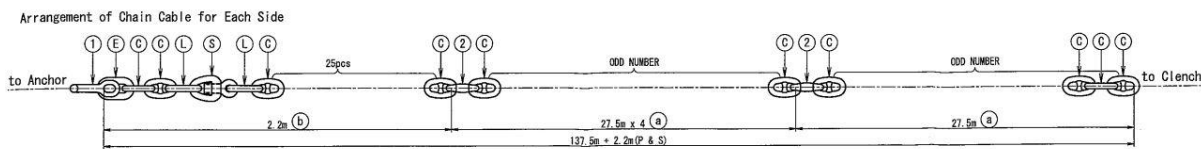

**Supply, Delivery and Installation of Anchor Chains and
it's Associated Components Intended for Ten (10) MRRVs**

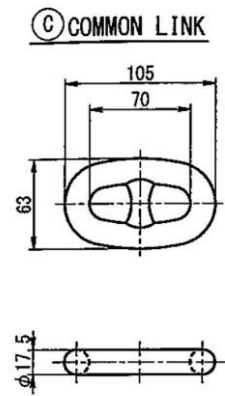

II. Anchor

- BRP CAPONES (MRRV-4404)
- Stockless Anchor **(315kg)**

**Supply, Delivery and Installation of Anchor Chains and
it's Associated Components Intended for Ten (10) MRRVs**

Conforme:

[Signature of the Authorized Rep.]

[in the capacity of] (Please indicate position of Authorized Rep.)

Duly authorized to sign Bid for and on behalf of

(Please indicate name of company)

**Supply, Delivery and Installation of Anchor Chains and
it's Associated Components Intended for Ten (10) MRRVs**



Section VII. Technical Specifications

**Supply, Delivery and Installation of Anchor Chains and
it's Associated Components Intended for Ten (10) MRRVs**

Technical Specifications

SUPPLY, DELIVERY AND INSTALLATION OF ANCHOR CHAINS AND IT'S ASSOCIATED COMPONENTS INTENDED FOR TEN (10) MRRVs			
Description	QTY	UNIT	Statement of Compliance
A - FOR BRP TUBBATAHA (MRRV-4401)			
Labor components			
1. Mobilization, hauling/transport & installation of port and starboard side anchor chain.	1	Lot	
2. Repair, refurbishing and repainting of anchor house/lockers.	1	Lot	
3. Repair, refurbishing and re-padding of 2 sets of anchor windlass break pad.	2	Lots	
4. Test for satisfactory result.	1	Lot	
Material components			
1. Supply and delivery of stud link anchor chain 17.50 millimeters (mm) x 137.5 meters (m) Materials: Grade 3 (for port and starboard side)	10	Shots	
2. Supply and delivery of Common link (C), End link (E), End shackle (1), Enlarged link (L), Swivel (S) Materials: Grade 3 (for port and starboard side)	1	Lot	
3. Bituminous paint solution, brushes, sand papers and other consumables.	1	Lot	
B - FOR BRP MALABRIGO (MRRV-4402)			
Labor components			
1. Mobilization, hauling/transport & installation of port and starboard side anchor chain.	1	Lot	

**Supply, Delivery and Installation of Anchor Chains and
it's Associated Components Intended for Ten (10) MRRVs**

2.	Repair, refurbishing and repainting of anchor house/lockers.	1	Lot	
3.	Repair, refurbishing and re-padding of 2 sets of anchor windlass break pad.	2	Lots	
4.	Test for satisfactory result.	1	Lot	
Material components				
1.	Supply and delivery of stud link anchor chain 17.50 millimeters (mm) x 137.5 meters (m) Materials: Grade 3 (for port and starboard side)	10	Shots	
2.	Supply and delivery of Common link (C), End link (E), End shackle (1), Enlarged link (L), Swivel (S) Materials: Grade 3 (for port and starboard side)	1	Lot	
3.	Bituminous paint solution, brushes, sand papers and other consumables.	1	Lot	
C - FOR BRP MALAPASCUA (MRRV-4403)				
Labor components				
1.	Mobilization, hauling/transport & installation of port and starboard side anchor chain.	1	Lot	
2.	Repair, refurbishing and repainting of anchor house/lockers.	1	Lot	
3.	Repair, refurbishing and re-padding of 2 sets of anchor windlass break pad.	2	Lots	
4.	Test for satisfactory result	1	Lot	
Material components				
1.	Supply and delivery of stud link anchor chain 17.50 millimeters (mm) x 137.5 meters (m) Materials: Grade 3 (for port and starboard side)	10	Shots	
2.	Supply and delivery of Common link (C),	1	Lot	

**Supply, Delivery and Installation of Anchor Chains and
it's Associated Components Intended for Ten (10) MRRVs**

End link (E), End shackle (1), Enlarged link (L), Swivel (S)			
Materials: Grade 3 (for port and starboard side)			
3. Bituminous paint solution, brushes, sand papers and other consumables.	1	Lot	
D - FOR BRP CAPONES (MRRV-4404)			
Labor components			
1. Mobilization, hauling/transport & installation of port and starboard side anchor chain.	1	Lot	
2. Repair, refurbishing and repainting of anchor house/lockers.	1	Lot	
3. Repair, refurbishing and re-padding of 2 sets of anchor windlass break pad.	2	Lots	
4. Test for satisfactory result.	1	Lot	
Material components			
1. Supply and delivery of stud link anchor chain 17.50 millimeters (mm) x 137.5 meters (m) Materials: Grade 3 (for port and starboard side)	10	Shots	
2. Supply and delivery of Common link (C), End link (E), End shackle (1), Enlarged link (L), Swivel (S) Materials: Grade 3 (for port and starboard side)	1	Lot	
3. Bituminous paint solution, brushes, sand papers and other consumables.	1	Lot	
4. Stockless Anchor (315kg)	1	Lot	
E - FOR BRP SULUAN (MRRV-4406)			
Labor components			
1. Mobilization, hauling/transport & installation of port and starboard side anchor chain.	1	Lot	

**Supply, Delivery and Installation of Anchor Chains and
it's Associated Components Intended for Ten (10) MRRVs**

2.	Repair, refurbishing and repainting of anchor house/lockers.	1	Lot	
3.	Repair, refurbishing and re-padding of 2 sets of anchor windlass break pad.	2	Lots	
4.	Test for satisfactory result.	1	Lot	
Material components				
1.	Supply and delivery of stud link anchor chain 17.50 millimeters (mm) x 137.5 meters (m) Materials: Grade 3 (for port and starboard side)	10	Shots	
2.	Supply and delivery of Common link (C), End link (E), End shackle (1), Enlarged link (L), Swivel (S) Materials: Grade 3 (for port and starboard side)	1	Lot	
3.	Bituminous paint solution, brushes, sand papers and other consumables.	1	Lot	
F - FOR BRP SINDANGAN (MRRV-4407)				
Labor components				
1.	Mobilization, hauling/transport & installation of port and starboard side anchor chain.	1	Lot	
2.	Repair, refurbishing and repainting of anchor house/lockers.	1	Lot	
3.	Repair, refurbishing and re-padding of 2 sets of anchor windlass break pad.	2	Lots	
4.	Test for satisfactory result.	1	Lot	
Material components				
1.	Supply and delivery of stud link anchor chain 17.50 millimeters (mm) x 137.5 meters (m) Materials: Grade 3 (for port and starboard side)	10	Shots	

**Supply, Delivery and Installation of Anchor Chains and
it's Associated Components Intended for Ten (10) MRRVs**

2.	Supply and delivery of Common link (C), End link (E), End shackle (1), Enlarged link (L), Swivel (S) Materials: Grade 3 (for port and starboard side)	1	Lot	
3.	Bituminous paint solution, brushes, sand papers and other consumables.	1	Lot	
G - FOR BRP CAPE SAN AGUSTIN (MRRV-4408)				
Labor components				
1.	Mobilization, hauling/transport & installation of port and starboard side anchor chain.	1	Lot	
2.	Repair, refurbishing and repainting of anchor house/lockers.	1	Lot	
3.	Repair, refurbishing and re-padding of 2 sets of anchor windlass break pad.	2	Lots	
4.	Test for satisfactory result.	1	Lot	
Material components:				
1.	Supply and delivery of stud link anchor chain 17.50 millimeters (mm) x 137.5 meters (m) Materials: Grade 3 (for port and starboard side)	10	Shots	
2.	Supply and delivery of Common link (C), End link (E), End shackle (1), Enlarged link (L), Swivel (S) Materials: Grade 3 (for port and starboard side)	1	Lot	
3.	Bituminous paint solution, brushes, sand papers and other consumables.	1	Lot	
H - FOR BRP CABRA (MRRV-4409)				
Labor components				
1.	Mobilization, hauling/transport & installation of port and starboard side anchor chain.	1	Lot	

**Supply, Delivery and Installation of Anchor Chains and
it's Associated Components Intended for Ten (10) MRRVs**

2.	Repair, refurbishing and repainting of anchor house/lockers.	1	Lot	
3.	Repair, refurbishing and re-padding of 2 sets of anchor windlass break pad.	2	Lots	
4.	Test for satisfactory result.	1	Lot	
Material components				
1.	Supply and delivery of stud link anchor chain 17.50 millimeters (mm) x 137.5 meters (m) Materials: Grade 3 (for port and starboard side)	10	Shots	
2.	Supply and delivery of Common link (C), End link (E), End shackle (1), Enlarged link (L), Swivel (S) Materials: Grade 3 (for port and starboard side)	1	Lot	
3.	Bituminous paint solution, brushes, sand papers and other consumables.	1	Lot	
I - FOR BRP BAGACAY (MRRV-4410)				
Labor components				
1.	Mobilization, hauling/transport & installation of port and starboard side anchor chain.	1	Lot	
2.	Repair, refurbishing and repainting of anchor house/lockers.	1	Lot	
3.	Repair, refurbishing and re-padding of 2 sets of anchor windlass break pad.	2	Lots	
4.	Test for satisfactory result.	1	Lot	
Material components				
1.	Supply and delivery of stud link anchor chain 17.50 millimeters (mm) x 137.5 meters (m) Materials: Grade 3 (for port and starboard side)	10	Shots	

**Supply, Delivery and Installation of Anchor Chains and
it's Associated Components Intended for Ten (10) MRRVs**

2.	Supply and delivery of Common link (C), End link (E), End shackle (1), Enlarged link (L), Swivel (S) Materials: Grade 3 (for port and starboard side)	1	Lot	
3.	Bituminous paint solution, brushes, sand papers and other consumables.	1	Lot	
J - FOR BRP CAPE ENGANO (MRRV-4411)				
Labor components				
1.	Mobilization, hauling/transport & installation of port and starboard side anchor chain.	1	Lot	
2.	Repair, refurbishing and repainting of anchor house/lockers.	1	Lot	
3.	Repair, refurbishing and re-padding of 2 sets of anchor windlass break pad.	2	Lots	
4.	Test for satisfactory result.	1	Lot	
Material components				
1.	Supply and delivery of stud link anchor chain 17.50 millimeters (mm) x 137.5 meters (m) Materials: Grade 3 (for port and starboard side)	10	Shots	
2.	Supply and delivery of Common link (C), End link (E), End shackle (1), Enlarged link (L), Swivel (S) Materials: Grade 3 (for port and starboard side)	1	Lot	
3.	Bituminous paint solution, brushes, sand papers and other consumables.	1	Lot	
ITEM	UNIT	QUANTITY	TOTAL QUANTITY FOR ALL MRRVs (PORT AND STARBOARD SIDE) (X 20)	

**Supply, Delivery and Installation of Anchor Chains and
it's Associated Components Intended for Ten (10) MRRVs**

End link	pc	1	20	
End shackle	pc	1	20	
Enlarge link	pcs	2	40	
Kenter shackle	pcs	2	40	
Swivel	Pc	1	20	
Stud link	Meters	137.5	2,750	

Dimensions and Specifications:

Stud link anchor chain

- 17.5 mm (diameter)
- 27.5 m per shot x 5 shots = 137.5 meters
- 137.5 m x 2 (port and starboard anchor chain) = 275 meters per MRRV
- 275 m x 10 (MRRV) = **2,750 meters**
- **Chain Link Size:** Outside Length (105 mm), Outside Width (63 mm)
- **Grade:** Grade 3 (Proof Load at least 179 kN), (Breaking Load at least 256 kN)
- **Paint:** Bituminous paint solutions

III. Anchor Chain

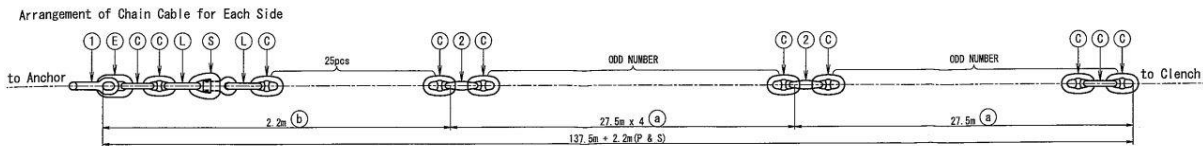

COMMON LINK

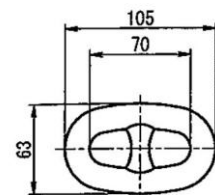

**Supply, Delivery and Installation of Anchor Chains and
it's Associated Components Intended for Ten (10) MRRVs**

IV. Anchor

- BRP CAPONES (MRRV-4404)
- Stockless Anchor **(315kg)**

**Supply, Delivery and Installation of Anchor Chains and
it's Associated Components Intended for Ten (10) MRRVs**

Delivery and Inspection Site:	
Project Completion Period: Within Ninety (90) calendar days from receipt of Notice to Proceed.	
Project Delivery Site: Aboard Coast Guard Surface Support Force, Pier 13, South Harbor, Port Area, Manila.	

Supply, Delivery and Installation of Anchor Chains and it's Associated Components Intended for Ten (10) MRRVs

A. Installation Site:		
No.	Vessel	Location
1	BRP TUBBATAHA (MRRV-4401)	General Santos City
2	BRP MALABRIGO (MRRV-4402)	Manila
3	BRP MALAPASCUA (MRRV-4403)	Palawan
4	BRP CAPONES (MRRV-4404)	Manila
5	BRP SULUAN (MRRV-4406)	Negros Oriental
6	BRP SINDANGAN (MRRV-4407)	Manila
7	BRP CAPE SAN AGUSTIN (MRRV-4408)	Davao City
8	BRP CABRA (MRRV-4409)	Palawan
9	BRP BAGACAY (MRRV-4410)	Cotabato City
10	BRP CAPE ENGANO (MRRV-4411)	Iloilo City
Note: Location of the vessel are subject to change.		
Warranty: <ul style="list-style-type: none"> One (1) year warranty after issuance of the Certificate of Final Acceptance. The one (1) year warranty period shall be reckoned from the date of issuance of the certificate of final acceptance. However, if the same defects occurred for two (2) consecutive times within the warranty period on a particular part/item and its attendant part, the warranty period shall be automatically extended for a period of six (6) months after the expiration of the original warranty period. The said item should be replaced with 30 days from the receipt notice. 		
Payment <p>Payment should be made after the completion and acceptance of the Supply and Delivery and Installation of Anchor Chains and it's Associated Components intended for ten (10) MRRVs.</p>		

Conforme:

[Signature of the Authorized Rep.]

[in the capacity of] (Please indicate position
of Authorized Rep.)

Duly authorized to sign Bid for and on behalf of
(Please indicate name of company)

**Supply, Delivery and Installation of Anchor Chains and
it's Associated Components Intended for Ten (10) MRRVs**



***Section VIII. Checklist of Technical and
Financial Documents***

**Supply, Delivery and Installation of Anchor Chains and
it's Associated Components Intended for Ten (10) MRRVs**

Checklist of Technical and Financial Documents

Each Bidder shall submit one **(1) original** and **six (6) copies** of the first and second components of its bid through their duly authorized representatives.

All envelopes shall:

- a. contain the name of the contract to be bid in **capital letters**;
- b. bear the name and address of the Bidder in capital letters;
- c. be addressed to the BAC with the following details:

**BIDS AND AWARDS COMMITTEE (BAC)
PHILIPPINE COAST GUARD – NATIONAL HEADQUARTERS**

- d. bear the specific identification of this bidding process; and

Supply, Delivery and Installation of Anchor Chains and it's Associated Components Intended for Ten (10) MRRVs

- e. bear a warning “**DO NOT OPEN BEFORE...**” the date and time for the opening of bids.

I. TECHNICAL COMPONENT ENVELOPE

Class “A” Documents

Legal Documents

- ☐ Valid and updated Philippine Government Electronic Procurement System (PhilGEPS) Platinum Certificate of Registration and Membership in accordance with Section 8.5.2 of the 2016 Revised IRR of RA 9184; Provided that all of the eligibility documents submitted to PhilGEPS are maintained and updated;

OR

In case any of the eligibility documents submitted to PhilGEPS is not updated, combination of a PhilGEPS Platinum Certificate of Registration and Membership, with any of the valid/updated Class “A” Eligibility Documents shall be submitted:

1. Securities and Exchange Commission (SEC) Registration Certificate for corporations, partnerships and/or joint ventures, Department of Trade and Industry (DTI) Registration Certificate for sole proprietorship, or Cooperative Development Authority (CDA) Registration Certificate for cooperatives; **AND/OR**
2. Valid Mayor’s or Business Permit issued by the city or municipality where the principal place of business of the prospective bidder is located, or the equivalent document for Exclusive Economic Zones or Areas.

In cases of recently expired Mayor’s/Business Permits, it shall be accepted together with the official receipt as proof that the bidder has applied for the renewal within the period prescribed by the concerned local government unit, provided that the renewed permit shall be submitted as a post-qualification requirement in accordance with Section 34.2 of the 2016 Revised IRR of R.A. 9184; **AND/OR**

3. Valid Tax Clearance Certificate per Executive Order (E.O.) No. 398, series of 2005, as finally reviewed and approved by the Bureau of Internal Revenue (BIR); **AND/OR**
4. Latest Audited Financial Statements (AFS), stamped “received” by the BIR or its duly accredited and authorized institutions, for the preceding calendar year. In case the AFS for the preceding calendar year is not yet available, said AFS should not be earlier than two (2) years from the deadline for the Submission and Receipt of Bids.

OR;

In lieu of the PhilGEPS Platinum Certificate of Registration and Membership, bidders shall submit all of the proceeding valid and/or updated Class “A” Eligibility Documents; Provided that the bidder having the LCB/SCB submit/s a

Supply, Delivery and Installation of Anchor Chains and it's Associated Components Intended for Ten (10) MRRVs

valid and updated PhilGEPS Platinum Certificate of Registration and Membership within five (5) calendar days from receipt of the BAC notice of the LCB/SCB during the post-qualification process

1. SEC Registration Certificate for corporations, partnerships and/or joint ventures, DTI Registration Certificate for sole proprietorship, or CDA Registration Certificate for cooperatives;
2. Valid Mayor's or Business Permit issued by the city or municipality where the principal place of business of the prospective bidder is located, or the equivalent document for Exclusive Economic Zones or Areas.

In cases of recently expired Mayor's/Business Permits, it shall be accepted together with the official receipt as proof that the bidder has applied for the renewal within the period prescribed by the concerned local government unit, provided that the renewed permit shall be submitted as a post-qualification requirement in accordance with Section 34.2 of the 2016 Revised IRR of R.A. 9184;

3. Valid Tax Clearance Certificate per Executive Order (E.O.) No. 398, series of 2005, as finally reviewed and approved by the Bureau of Internal Revenue (BIR); **AND**
4. Latest AFS stamped "received" by the BIR or its duly accredited and authorized institutions, for the preceding calendar year. In case the AFS for the preceding calendar year is not yet available, said AFS should not be earlier than two (2) years from the deadline for the Submission and Receipt of Bids.

Technical Documents

- ☐ (f) Statement of the prospective bidder of all its ongoing government and private contracts, including contracts awarded but not yet started, if any, whether similar or not similar in nature and complexity to the contract to be bid.

The Statement of all On-going Government and Private Contracts shall indicate for each contract, the following:

- name of the contract;
- date of the contract;
- contract period;
- owner's name and address;
- kinds of goods;
- amount of contract and value of outstanding contracts;
- date of delivery (please state estimated date of delivery)

Bidders are also required to attached the following: (if applicable)

- Notice to Proceed
- Purchase Order

Supply, Delivery and Installation of Anchor Chains and it's Associated Components Intended for Ten (10) MRRVs

- ☐ (g) Statement of the bidder's Single Largest Completed Contract (SLCC) similar to the contract to be bid, which should have been completed within five (5) years prior to the deadline for the submission and receipt of bids and equivalent to at least twenty-five percent (25%) of the ABC or not less than the amount of One Million Nine Hundred Fifty-Four Thousand Forty-Three Pesos and 33/100 (PhP1,954,043.33).

The statement identifying the Single Largest Completed Contract (SLCC) shall indicate the following:

- (a) name of the contract;
- (b) date of the contract;
- (c) contract period;
- (d) owner's name and address;
- (e) kinds of goods;
- (f) amount of completed contracts, adjusted by the bidder to current prices using PSA's consumer price index, if necessary for purposes of meeting the SLCC requirement;
- (h) date of delivery (actual date of delivery for the single largest completed contract); and
- (i) end user's acceptance or official receipt(s) or sales invoice issued for the contract, Notice to Proceed and Purchase Order which shall be attached to the statement of SLCC.

For purposes of post-qualification, bidders are required to attach the entire set of the Contract, Purchase Order or Memorandum of Agreement to the Statement Identifying the SLCC.

Bidders are also required to Include in the aforesaid Statement of All On-going Government and Private Contracts and Statement Identifying the SLCC the following information:

- a) Contact Person; and
- b) Contact Details (telephone/fax/cellphone number and/or email address)

- ☐ (h) Original copy of Bid Security. If in the form of a Surety Bond, submit also a certification issued by the Insurance Commission, based on the following schedule:

<p>a) Cash, cashier's/ manager's check issued by a Universal or Commercial Bank;</p> <p>b) Bank draft/ guarantee or irrevocable letter of credit issued by a Universal or Commercial Bank; Provided, however, that it shall be confirmed or authenticated by a Universal or Commercial Bank, if issued by a foreign bank</p>	<p>c) Surety Bond, callable upon demand issued by a surety or insurance company duly certified by the Insurance Commission authorized to issue said security specific for the project</p> <p>[at least Five Percent (5%) of the ABC]</p>
--	--

**Supply, Delivery and Installation of Anchor Chains and
it's Associated Components Intended for Ten (10) MRRVs**

[at least Two Percent (2%) of the ABC]	
Php 156,323.67	PhP 390,808.67),

OR;

- ☒ Original copy of Notarized Bid Securing Declaration; **and**
- ☐ (i) Conformity with the Schedule of Requirements; **and**
- ☒ (j) Conformity with the Technical Specifications and duly signed by the bidder's authorized representative; **and**
- ☐ (k) Original duly signed Omnibus Sworn Statement (OSS); **and** if applicable, Original Special Power of Attorney for sole proprietorships, Notarized Secretary's Certificate/Board Partnership Resolution in case of a corporation, partnership, or cooperative; or Original Special Power of Attorney of all members of the joint venture giving full power and authority to its officer to sign the OSS and do acts to represent the Bidder.

Reminder: If the prospective bidder's representative who will attend the Submission, Receipt, Opening and Preliminary Examination of Bids is different from the authorized representative to do, execute and perform any and all acts necessary and/or to represent the prospective bidder in the bidding, then the prospective bidder can include the name/s of said representative in the above-mentioned proofs of authorization (*e.g., original copy of the duly notarized Secretary's Certificate for corporations, Board/Partnership Resolution for partnerships, corporations, and/or joint ventures or an original copy of the Special Power of Attorney for sole proprietorships, whichever is applicable*)

☐

Financial Documents

☐

The prospective bidder's computation of Net Financial Contracting Capacity (NFCC) which must be at least to the ABC amounting to Seven Million Eight Hundred Sixteen Thousand One Hundred Seventy-Three Pesos and 33/100 (PhP7,816, 173.33)

☒

Bidders must submit a computation of its NFCC, which must be at least equal to the ABC, calculated as follows:

Supply, Delivery and Installation of Anchor Chains and it's Associated Components Intended for Ten (10) MRRVs

NFCC = [(Current assets minus current liabilities) **(15)**] minus the value of all outstanding or uncompleted portions of the projects under ongoing contracts, including awarded contracts yet to be started, coinciding with the contract to be bid.

The values of the domestic bidder's current assets and current liabilities shall be based on the latest Audited Financial Statements submitted to the BIR.

For purposes of computing the foreign bidders' NFCC, the value of the current assets and current liabilities shall be based on their audited financial statements prepared in accordance with international financial reporting standards.

OR;

A committed Line of Credit from a Universal or Commercial Bank in lieu of its NFCC computation.

If the prospective bidder opts to submit a committed Line of Credit, it must be at least equal to ten percent (10%) of the ABC to be bid or not less than the amount of Seven Hundred Eighty-One Thousand Six Hundred Seventeen Pesos and 33/100 (PhP781,617.33) if issued by a foreign universal or commercial bank, it shall be confirmed or authenticated by a local universal or commercial bank.

Class "B" Documents

- ☐ (1) If applicable, a duly signed joint venture agreement (JVA) in case the joint venture is already in existence;

OR;

duly notarized statements from all the potential joint venture partners stating that they will enter into and abide by the provisions of the JVA in the instance that the bid is successful.

Failure to enter into a joint venture in the event of a contract award shall be ground for the forfeiture of the bid security.

Each partner of the joint venture shall submit their respective valid and updated PhilGEPS Certificates of Registration in accordance with Section 8.5.2 of the 2016 Revised Implementing Rules and Regulations (IRR) of Republic Act (R.A.) No. 9184.

In case any of the eligibility documents submitted to PhilGEPS by any of the partners of the joint venture is not updated, a combination of a valid PhilGEPS Platinum Certificate of Registration and Membership, with any of the valid/updated Class "A" Eligibility Documents shall be submitted:

- SEC Registration Certificate for corporations, partnerships

Supply, Delivery and Installation of Anchor Chains and it's Associated Components Intended for Ten (10) MRRVs

and/or joint ventures; DTI Registration Certificate for sole proprietorship; or CDA Registration Certificate for cooperatives;

- Valid Mayor's or Business Permit issued by the city or municipality where the principal place of business of the prospective bidder is located, or the equivalent document for Exclusive Economic Zones or Areas;
- Valid Tax Clearance Certificate; and
- Latest AFS, stamped "received" by the BIR or its duly accredited and authorized institutions, for the preceding calendar year.

In the event that one of the partners of the joint venture does not have a valid and updated PhilGEPS Certificate of Registration and Platinum Membership, then it shall submit the following eligibility documents:

- SEC Registration Certificate for corporations, partnerships and/or joint ventures; DTI Registration Certificate for sole proprietorship; or CDA Registration Certificate for cooperatives;
- Valid Mayor's Permit issued by the city or municipality where the principal place of business of the prospective bidder is located, or the equivalent document for Exclusive Economic Zones or Areas;
- Valid Tax Clearance Certificate; and
- Latest AFS, stamped "received" by the BIR or its duly accredited and authorized institutions, for the preceding calendar year.

The submission of technical and financial eligibility documents by any of the joint venture partners constitutes compliance: *Provided*, That the partner responsible to submit the NFCC shall likewise submit the Statement of all of its ongoing contracts and Audited Financial Statements.

24 FINANCIAL COMPONENT ENVELOPE

- (a) Original of duly signed and accomplished Financial Bid Form;
- And**
- (b) Original of duly signed and accomplished Price Schedule(s).

All financial bids shall be rounded up to two (2) decimal places.

**Supply, Delivery and Installation of Anchor Chains and
it's Associated Components Intended for Ten (10) MRRVs**



Section IX. Bidding Forms

TABLE OF CONTENTS

BID FORM	51
PRICE SCHEDULES.....	53
CONTRACT AGREEMENT.....	55
OMNIBUS SWORN STATEMENT	63
BANK GUARANTEE FOR ADVANCE PAYMENT.....	66
BID SECURING DECLARATION	67
STATEMENT OF ALL ON-GOING CONTRACTS.....	69
STATEMENT OF THE SINGLE LARGEST COMPLETED CONTRACT.....	70
NFCC COMPUTATION.....	71
PERFORMANCE SECURING DECLARATION.....	72
DIAGRAM FOR THE SEALING AND MARKING OF BIDS.....	74

**Supply, Delivery and Installation of Anchor Chains and
it's Associated Components Intended for Ten (10) MRRVs**

BID FORM

Date : _____
Project Identification No. _____

To: [name and address of Procuring Entity]

Having examined the Philippine Bidding Documents (PBDs) including the Supplemental or Bid Bulletin Numbers *[insert numbers]*, the receipt of which is hereby duly acknowledged, we, the undersigned, offer to *[supply/deliver/perform]* *[description of the Goods]* in conformity with the said PBDs for the sum of *[total Bid amount in words and figures]* or the total calculated bid price, as evaluated and corrected for computational errors, and other bid modifications in accordance with the Price Schedules attached herewith and made part of this Bid. The total bid price includes the cost of all taxes, such as, but not limited to: *[specify the applicable taxes, e.g. (i) value added tax (VAT), (ii) income tax, (iii) local taxes, and (iv) other fiscal levies and duties]*, which are itemized herein or in the Price Schedules,

If our Bid is accepted, we undertake:

- a. to deliver the goods in accordance with the delivery schedule specified in the Schedule of Requirements of the Philippine Bidding Documents (PBDs);
- b. to provide a performance security in the form, amounts, and within the times prescribed in the PBDs;
- c. to abide by the Bid Validity Period specified in the PBDs and it shall remain binding upon us at any time before the expiration of that period.

[Insert this paragraph if Foreign-Assisted Project with the Development Partner:

Commissions or gratuities, if any, paid or to be paid by us to agents relating to this Bid, and to contract execution if we are awarded the contract, are listed below:

Name and address Amount and Purpose of of agent Currency, Commission or gratuity

(if none, state "None")]

Until a formal Contract is prepared and executed, this Bid, together with your written acceptance thereof and your Notice of Award, shall be binding upon us.

**Supply, Delivery and Installation of Anchor Chains and
it's Associated Components Intended for Ten (10) MRRVs**

We understand that you are not bound to accept the Lowest Calculated Bid or any Bid you may receive.

We certify/confirm that we comply with the eligibility requirements pursuant to the PBDs.

The undersigned is authorized to submit the bid on behalf of *[name of the bidder]* as evidenced by the attached *[state the written authority]*.

We acknowledge that failure to sign each and every page of this Bid Form, including the attached Schedule of Prices, shall be a ground for the rejection of our bid.

Name: _____

Legal capacity:

Signature: _____

Duly authorized to sign the Bid for and behalf of: _____

Date: _____

**Supply, Delivery and Installation of Anchor Chains and
it's Associated Components Intended for Ten (10) MRRVs**

**For Goods Offered From Abroad
[shall be submitted with the Bid if bidder is offering goods from Abroad]**

**Kindly supply the required information in the spaces provided. Do not forget to indicate the “Country of Origin” of the goods offered.
Any alteration to any of the terms and conditions contained in the document may cause your disqualification except if said alteration or
revision is a result of a Supplemental/Bid Bulletin.**

Name of Bidder _____. Invitation to Bid Number __. Page ____.

Item	Description	Quantity	Unit	Country of origin	Unit price CIF port of entry (specify port) or CIP named place (specify border point or place of destination)	Total CIF or CIP price per item (col. 4 x 5)	Unit Price Delivered Duty Unpaid (DDU)	Unit price Delivered Duty Paid (DDP)	Total Price delivered DDP (col 4 x 8)
1.	A - FOR BRP TUBBATAHA (MRRV-4401)								
	Labor components								
5.	Mobilization, hauling/transport & installation of port and starboard side anchor chain.	1	Lot						
6.	Repair, refurbishing and repainting of anchor house/lockers.	1	Lot						
7.	Repair, refurbishing and re-padding of 2 sets of anchor windlass break pad.	2	Lots						
8.	Test for satisfactory result.	1	Lot						
	Material components								

**Supply, Delivery and Installation of Anchor Chains and
it's Associated Components Intended for Ten (10) MRRVs**

4.	Supply and delivery of stud link anchor chain 17.50 millimeters (mm) x 137.5 meters (m) Materials: Grade 3 (for port and starboard side)	10	Shots						
5.	Supply and delivery of Common link (C), End link (E), End shackle (1), Enlarged link (L), Swivel (S) Materials: Grade 3 (for port and starboard side)	1	Lot						
6.	Bituminous paint solution, brushes, sand papers and other consumables.	1	Lot						
B - FOR BRP MALABRIGO (MRRV-4402)									
Labor components									
5.	Mobilization, hauling/transport & installation of port and starboard side anchor chain.	1	Lot						
6.	Repair, refurbishing and repainting of anchor house/lockers.	1	Lot						
7.	Repair, refurbishing and re-padding of 2 sets of anchor windlass break pad.	2	Lots						
8.	Test for satisfactory result.	1	Lot						
Material components									

**Supply, Delivery and Installation of Anchor Chains and
it's Associated Components Intended for Ten (10) MRRVs**

4.	Supply and delivery of stud link anchor chain 17.50 millimeters (mm) x 137.5 meters (m) Materials: Grade 3 (for port and starboard side)	10	Shots						
5.	Supply and delivery of Common link (C), End link (E), End shackle (1), Enlarged link (L), Swivel (S) Materials: Grade 3 (for port and starboard side)	1	Lot						
6.	Bituminous paint solution, brushes, sand papers and other consumables.	1	Lot						
C - FOR BRP MALAPASCUA (MRRV-4403)									
Labor components									
5.	Mobilization, hauling/transport & installation of port and starboard side anchor chain.	1	Lot						
6.	Repair, refurbishing and repainting of anchor house/lockers.	1	Lot						
7.	Repair, refurbishing and re-padding of 2 sets of anchor windlass break pad.	2	Lots						
8.	Test for satisfactory result	1	Lot						
Material components									

**Supply, Delivery and Installation of Anchor Chains and
it's Associated Components Intended for Ten (10) MRRVs**

4.	Supply and delivery of stud link anchor chain 17.50 millimeters (mm) x 137.5 meters (m) Materials: Grade 3 (for port and starboard side)	10	Shots						
5.	Supply and delivery of Common link (C), End link (E), End shackle (1), Enlarged link (L), Swivel (S) Materials: Grade 3 (for port and starboard side)	1	Lot						
6.	Bituminous paint solution, brushes, sand papers and other consumables.	1	Lot						
D - FOR BRP CAPONES (MRRV-4404)									
Labor components									
5.	Mobilization, hauling/transport & installation of port and starboard side anchor chain.	1	Lot						
6.	Repair, refurbishing and repainting of anchor house/lockers.	1	Lot						
7.	Repair, refurbishing and re-padding of 2 sets of anchor windlass break pad.	2	Lots						
8.	Test for satisfactory result.	1	Lot						
Material components									

**Supply, Delivery and Installation of Anchor Chains and
it's Associated Components Intended for Ten (10) MRRVs**

5.	Supply and delivery of stud link anchor chain 17.50 millimeters (mm) x 137.5 meters (m) Materials: Grade 3 (for port and starboard side)	10	Shots						
6.	Supply and delivery of Common link (C), End link (E), End shackle (1), Enlarged link (L), Swivel (S) Materials: Grade 3 (for port and starboard side)	1	Lot						
7.	Bituminous paint solution, brushes, sand papers and other consumables.	1	Lot						
8.	Stockless Anchor (315kg)	1	Lot						
E - FOR BRP SULUAN (MRRV-4406)									
Labor components									
5.	Mobilization, hauling/transport & installation of port and starboard side anchor chain.	1	Lot						
6.	Repair, refurbishing and repainting of anchor house/lockers.	1	Lot						
7.	Repair, refurbishing and re-padding of 2 sets of anchor windlass break pad.	2	Lots						
8.	Test for satisfactory result.	1	Lot						

**Supply, Delivery and Installation of Anchor Chains and
it's Associated Components Intended for Ten (10) MRRVs**

	Material components								
4.	Supply and delivery of stud link anchor chain 17.50 millimeters (mm) x 137.5 meters (m) Materials: Grade 3 (for port and starboard side)	10	Shots						
5.	Supply and delivery of Common link (C), End link (E), End shackle (1), Enlarged link (L), Swivel (S) Materials: Grade 3 (for port and starboard side)	1	Lot						
6.	Bituminous paint solution, brushes, sand papers and other consumables.	1	Lot						
	F - FOR BRP SINDANGAN (MRRV-4407)								
	Labor components								
5.	Mobilization, hauling/transport & installation of port and starboard side anchor chain.	1	Lot						
6.	Repair, refurbishing and repainting of anchor house/lockers.	1	Lot						
7.	Repair, refurbishing and re-padding of 2 sets of anchor windlass break pad.	2	Lots						
8.	Test for satisfactory result.	1	Lot						

**Supply, Delivery and Installation of Anchor Chains and
it's Associated Components Intended for Ten (10) MRRVs**

	Material components								
	4. Supply and delivery of stud link anchor chain 17.50 millimeters (mm) x 137.5 meters (m) Materials: Grade 3 (for port and starboard side)	10	Shots						
	5. Supply and delivery of Common link (C), End link (E), End shackle (1), Enlarged link (L), Swivel (S) Materials: Grade 3 (for port and starboard side)	1	Lot						
	6. Bituminous paint solution, brushes, sand papers and other consumables.	1	Lot						
	G - FOR BRP CAPE SAN AGUSTIN (MRRV-4408)								
	Labor components								
	5. Mobilization, hauling/transport & installation of port and starboard side anchor chain.	1	Lot						
	6. Repair, refurbishing and repainting of anchor house/lockers.	1	Lot						
	7. Repair, refurbishing and re-padding of 2 sets of anchor windlass break pad.	2	Lots						

**Supply, Delivery and Installation of Anchor Chains and
it's Associated Components Intended for Ten (10) MRRVs**

8.	Test for satisfactory result.	1	Lot						
	Material components:								
4.	Supply and delivery of stud link anchor chain 17.50 millimeters (mm) x 137.5 meters (m) Materials: Grade 3 (for port and starboard side)	10	Shots						
5.	Supply and delivery of Common link (C), End link (E), End shackle (1), Enlarged link (L), Swivel (S) Materials: Grade 3 (for port and starboard side)	1	Lot						
6.	Bituminous paint solution, brushes, sand papers and other consumables.	1	Lot						
	H - FOR BRP CABRA (MRRV-4409)								
	Labor components								
5.	Mobilization, hauling/transport & installation of port and starboard side anchor chain.	1	Lot						
6.	Repair, refurbishing and repainting of anchor house/lockers.	1	Lot						
7.	Repair, refurbishing and re-padding of 2 sets of anchor windlass break pad.	2	Lots						

**Supply, Delivery and Installation of Anchor Chains and
it's Associated Components Intended for Ten (10) MRRVs**

8.	Test for satisfactory result.	1	Lot						
	Material components								
4.	Supply and delivery of stud link anchor chain 17.50 millimeters (mm) x 137.5 meters (m) Materials: Grade 3 (for port and starboard side)	10	Shots						
5.	Supply and delivery of Common link (C), End link (E), End shackle (1), Enlarged link (L), Swivel (S) Materials: Grade 3 (for port and starboard side)	1	Lot						
6.	Bituminous paint solution, brushes, sand papers and other consumables.	1	Lot						
	I - FOR BRP BAGACAY (MRRV-4410)								
	Labor components								
5.	Mobilization, hauling/transport & installation of port and starboard side anchor chain.	1	Lot						
6.	Repair, refurbishing and repainting of anchor house/lockers.	1	Lot						
7.	Repair, refurbishing and re-padding of 2 sets of anchor windlass break pad.	2	Lots						

**Supply, Delivery and Installation of Anchor Chains and
it's Associated Components Intended for Ten (10) MRRVs**

8.	Test for satisfactory result.	1	Lot						
	Material components								
4.	Supply and delivery of stud link anchor chain 17.50 millimeters (mm) x 137.5 meters (m) Materials: Grade 3 (for port and starboard side)	10	Shots						
5.	Supply and delivery of Common link (C), End link (E), End shackle (1), Enlarged link (L), Swivel (S) Materials: Grade 3 (for port and starboard side)	1	Lot						
6.	Bituminous paint solution, brushes, sand papers and other consumables.	1	Lot						
	J - FOR BRP CAPE ENGANO (MRRV-4411)								
	Labor components								
5.	Mobilization, hauling/transport & installation of port and starboard side anchor chain.	1	Lot						
6.	Repair, refurbishing and repainting of anchor house/lockers.	1	Lot						
7.	Repair, refurbishing and re-padding of 2 sets of anchor windlass break pad.	2	Lots						

**Supply, Delivery and Installation of Anchor Chains and
it's Associated Components Intended for Ten (10) MRRVs**

8.	Test for satisfactory result.	1	Lot						
	Material components								
4.	Supply and delivery of stud link anchor chain 17.50 millimeters (mm) x 137.5 meters (m) Materials: Grade 3 (for port and starboard side)	10	Shots						
5.	Supply and delivery of Common link (C), End link (E), End shackle (1), Enlarged link (L), Swivel (S) Materials: Grade 3 (for port and starboard side)	1	Lot						
6.	Bituminous paint solution, brushes, sand papers and other consumables.	1	Lot						
1.	End link	20	pc						
2.	End shackle	20	pc						
3.	Enlarge link	40	pcs						
4.	Kenter shackle	40	pcs						
5.	Swivel	20	Pc						
6.	Stud link	2,75 0	Meter s						

[Signature of the Authorized Rep.]

[in the capacity of] (Please indicate position of Authorized Rep.)]

Supply, Delivery and Installation of Anchor Chains and it's Associated Components Intended for Ten (10) MRRVs

Duly authorized to sign Bid for and on behalf of _____
(Please indicate name of company)

***BIDDERS SHALL NOT ALTER THIS FORM**

For Goods Offered From Within the Philippines
[shall be submitted with the Bid if bidder is offering goods from within the Philippines]

Kindly supply the required information in the spaces provided. Do not forget to indicate the "Country of Origin" of the goods offered. Prospective bidders have the option to indicate the appropriate amount, "0" or "Not Applicable (N/A)" for columns 6, 7 and 8. Any alteration to any of the terms and conditions contained in the document may cause your disqualification except if said alteration or revision is a result of a Supplemental/Bid Bulletin.

Name of Bidder _____. Invitation to Bid Number _____. Page _ of _____.

1	2	3		4	5	6	7	8	9	10
Item	Description	Quantity	Unit	Country of origin	Unit price EXW per item	Transportation and Insurance and all other costs incidental to delivery, per item	Sales and other taxes payable if Contract is awarded , per item	Cost of Incidental Services, if applicable, per item	Total Price, per unit (col 5+6+7+8)	Total Price delivered Final Destination (col 9) x (col 4)
1.	A - FOR BRP TUBBATAHA (MRRV-4401)									

**Supply, Delivery and Installation of Anchor Chains and
it's Associated Components Intended for Ten (10) MRRVs**

	Labor components								
9.	Mobilization, hauling/transport & installation of port and starboard side anchor chain.	1	Lot						
10.	Repair, refurbishing and repainting of anchor house/lockers.	1	Lot						
11.									
12.	Repair, refurbishing and re-padding of 2 sets of anchor windlass break pad.	2	Lots						
13.									
14.	Test for satisfactory result.	1	Lot						
15.									
16.	Material components								
7.	Supply and delivery of stud link anchor chain 17.50 millimeters (mm) x 137.5 meters (m)	10	Shots						
	Materials: Grade 3 (for port and starboard side)								
17.									
8.	Supply and delivery of Common link (C), End link (E), End shackle (1), Enlarged link (L), Swivel (S)	1	Lot						
	Materials: Grade 3 (for port and starboard side)								
9.									
10.	Bituminous paint solution, brushes, sand papers and other consumables.	1	Lot						
11.									
	B - FOR BRP MALABRIGO (MRRV-4402)								

**Supply, Delivery and Installation of Anchor Chains and
it's Associated Components Intended for Ten (10) MRRVs**

12.									
Labor components									
9.	Mobilization, hauling/transport & installation of port and starboard side anchor chain.	1	Lot						
10.	Repair, refurbishing and repainting of anchor house/lockers.	1	Lot						
11.									
12.	Repair, refurbishing and re-padding of 2 sets of anchor windlass break pad.	2	Lots						
13.									
14.	Test for satisfactory result.	1	Lot						
15.									
16.	Material components								
7.	Supply and delivery of stud link anchor chain 17.50 millimeters (mm) x 137.5 meters (m) Materials: Grade 3 (for port and starboard side)	10	Shots						
17.									
8.	Supply and delivery of Common link (C), End link (E), End shackle (1), Enlarged link (L), Swivel (S) Materials: Grade 3 (for port and starboard side)	1	Lot						
9.									
10.	Bituminous paint solution, brushes, sand papers and other consumables.	1	Lot						
11.									

**Supply, Delivery and Installation of Anchor Chains and
it's Associated Components Intended for Ten (10) MRRVs**

	C - FOR BRP MALAPASCUA (MRRV-4403)								
	12.								
	Labor components								
	9. Mobilization, hauling/transport & installation of port and starboard side anchor chain.	1	Lot						
	10. Repair, refurbishing and repainting of anchor house/lockers.	1	Lot						
	11.								
	12. Repair, refurbishing and re-padding of 2 sets of anchor windlass break pad.	2	Lots						
	13.								
	14. Test for satisfactory result	1	Lot						
	15.								
	16. Material components								
	7. Supply and delivery of stud link anchor chain 17.50 millimeters (mm) x 137.5 meters (m) Materials: Grade 3 (for port and starboard side)	10	Shots						
	17.								
	8. Supply and delivery of Common link (C), End link (E), End shackle (1), Enlarged link (L), Swivel (S) Materials: Grade 3 (for port and starboard side)	1	Lot						
	9.								
	10. Bituminous paint solution, brushes, sand papers and other consumables.	1	Lot						

**Supply, Delivery and Installation of Anchor Chains and
it's Associated Components Intended for Ten (10) MRRVs**

11.									
D - FOR BRP CAPONES (MRRV-4404)									
12.									
Labor components									
9. Mobilization, hauling/transport & installation of port and starboard side anchor chain.	1	Lot							
10. Repair, refurbishing and repainting of anchor house/lockers.	1	Lot							
11.									
12. Repair, refurbishing and re-padding of 2 sets of anchor windlass break pad.	2	Lots							
13.									
14. Test for satisfactory result.	1	Lot							
15.									
16. Material components									
9. Supply and delivery of stud link anchor chain 17.50 millimeters (mm) x 137.5 meters (m) Materials: Grade 3 (for port and starboard side)	10	Shots							
17.									
10. Supply and delivery of Common link (C), End link (E), End shackle (1), Enlarged link (L), Swivel (S) Materials: Grade 3 (for port and starboard side)	1	Lot							
11.									
12. Bituminous paint solution, brushes, sand	1	Lot							

**Supply, Delivery and Installation of Anchor Chains and
it's Associated Components Intended for Ten (10) MRRVs**

	papers and other consumables. 13.								
	14. Stockless Anchor (315kg) 15.	1	Lot						
	E - FOR BRP SULUAN (MRRV-4406) 16.								
	Labor components								
	9. Mobilization, hauling/transport & installation of port and starboard side anchor chain.	1	Lot						
	10. Repair, refurbishing and repainting of anchor house/lockers. 11.	1	Lot						
	12. Repair, refurbishing and re-padding of 2 sets of anchor windlass break pad. 13.	2	Lots						
	14. Test for satisfactory result. 15.	1	Lot						
	16. Material components								
	7. Supply and delivery of stud link anchor chain 17.50 millimeters (mm) x 137.5 meters (m) Materials: Grade 3 (for port and starboard side) 17.	10	Shots						
	8. Supply and delivery of Common link (C), End link (E), End shackle (1), Enlarged link (L), Swivel (S) Materials: Grade 3 (for port and starboard	1	Lot						

**Supply, Delivery and Installation of Anchor Chains and
it's Associated Components Intended for Ten (10) MRRVs**

	side) 9.								
	10. Bituminous paint solution, brushes, sand papers and other consumables. 11.	1	Lot						
	F - FOR BRP SINDANGAN (MRRV-4407) 12.								
	Labor components								
	9. Mobilization, hauling/transport & installation of port and starboard side anchor chain.	1	Lot						
	10. Repair, refurbishing and repainting of anchor house/lockers. 11.	1	Lot						
	12. Repair, refurbishing and re-padding of 2 sets of anchor windlass break pad. 13.	2	Lots						
	14. Test for satisfactory result. 15.	1	Lot						
	16. Material components								
	7. Supply and delivery of stud link anchor chain 17.50 millimeters (mm) x 137.5 meters (m) Materials: Grade 3 (for port and starboard side) 17.	10	Shots						
	8. Supply and delivery of Common link (C), End link (E), End shackle (1), Enlarged link (L), Swivel (S)	1	Lot						

**Supply, Delivery and Installation of Anchor Chains and
it's Associated Components Intended for Ten (10) MRRVs**

9.	Materials: Grade 3 (for port and starboard side)								
10.	Bituminous paint solution, brushes, sand papers and other consumables.	1	Lot						
11.									
12.	G - FOR BRP CAPE SAN AGUSTIN (MRRV-4408)								
	Labor components								
9.	Mobilization, hauling/transport & installation of port and starboard side anchor chain.	1	Lot						
10.	Repair, refurbishing and repainting of anchor house/lockers.	1	Lot						
11.									
12.	Repair, refurbishing and re-padding of 2 sets of anchor windlass break pad.	2	Lots						
13.									
14.	Test for satisfactory result.	1	Lot						
15.									
16.	Material components:								
7.	Supply and delivery of stud link anchor chain 17.50 millimeters (mm) x 137.5 meters (m)	10	Shots						
17.	Materials: Grade 3 (for port and starboard side)								
8.	Supply and delivery of Common link (C), End link (E), End shackle (1), Enlarged link	1	Lot						

**Supply, Delivery and Installation of Anchor Chains and
it's Associated Components Intended for Ten (10) MRRVs**

	(L), Swivel (S) Materials: Grade 3 (for port and starboard side)								
9.									
10.	Bituminous paint solution, brushes, sand papers and other consumables.	1	Lot						
11.									
	H - FOR BRP CABRA (MRRV-4409)								
12.									
	Labor components								
9.	Mobilization, hauling/transport & installation of port and starboard side anchor chain.	1	Lot						
10.	Repair, refurbishing and repainting of anchor house/lockers.	1	Lot						
11.									
12.	Repair, refurbishing and re-padding of 2 sets of anchor windlass break pad.	2	Lots						
13.									
14.	Test for satisfactory result.	1	Lot						
15.									
16.	Material components								
7.	Supply and delivery of stud link anchor chain 17.50 millimeters (mm) x 137.5 meters (m) Materials: Grade 3 (for port and starboard side)	10	Shots						
17.									
8.	Supply and delivery of Common link (C),	1	Lot						

Supply, Delivery and Installation of Anchor Chains and it's Associated Components Intended for Ten (10) MRRVs

9.	End link (E), End shackle (1), Enlarged link (L), Swivel (S) Materials: Grade 3 (for port and starboard side)								
10.	Bituminous paint solution, brushes, sand papers and other consumables.	1	Lot						
11.									
12.	I - FOR BRP BAGACAY (MRRV-4410)								
	Labor components								
9.	Mobilization, hauling/transport & installation of port and starboard side anchor chain.	1	Lot						
10.	Repair, refurbishing and repainting of anchor house/lockers.	1	Lot						
11.									
12.	Repair, refurbishing and re-padding of 2 sets of anchor windlass break pad.	2	Lots						
13.									
14.	Test for satisfactory result.	1	Lot						
15.									
16.	Material components								
17.	7. Supply and delivery of stud link anchor chain 17.50 millimeters (mm) x 137.5 meters (m) Materials: Grade 3 (for port and starboard side)	10	Shots						

**Supply, Delivery and Installation of Anchor Chains and
it's Associated Components Intended for Ten (10) MRRVs**

8.	Supply and delivery of Common link (C), End link (E), End shackle (1), Enlarged link (L), Swivel (S) Materials: Grade 3 (for port and starboard side)	1	Lot						
9.									
10.	Bituminous paint solution, brushes, sand papers and other consumables.	1	Lot						
11.									
	J - FOR BRP CAPE ENGANO (MRRV-4411)								
12.									
	Labor components								
9.	Mobilization, hauling/transport & installation of port and starboard side anchor chain.	1	Lot						
10.	Repair, refurbishing and repainting of anchor house/lockers.	1	Lot						
11.									
12.	Repair, refurbishing and re-padding of 2 sets of anchor windlass break pad.	2	Lots						
13.									
14.	Test for satisfactory result.	1	Lot						
15.									
16.	Material components								
7.	Supply and delivery of stud link anchor chain 17.50 millimeters (mm) x 137.5 meters (m) Materials: Grade 3 (for port and starboard side)	10	Shots						

**Supply, Delivery and Installation of Anchor Chains and
it's Associated Components Intended for Ten (10) MRRVs**

17.									
8.	Supply and delivery of Common link (C), End link (E), End shackle (1), Enlarged link (L), Swivel (S) Materials: Grade 3 (for port and starboard side)	1	Lot						
9.									
10.	Bituminous paint solution, brushes, sand papers and other consumables.	1	Lot						
11.									
12.									
13.	End link	20	pc						
14.	End shackle	20	pc						
15.	Enlarge link	40	pcs						
16.	Kenter shackle	40	pcs						
17.	Swivel	20	Pc						
18.	Stud link	2,750	Meters						

[Signature of the Authorized Rep.]

[in the capacity of] (Please indicate position of Authorized Rep.)]

Duly authorized to sign Bid for and on behalf of _____
(Please indicate name of company)

***BIDDERS SHALL NOT ALTER THIS FORM**

**Supply, Delivery and Installation of Anchor Chains and
it's Associated Components Intended for Ten (10) MRRVs**

Contract Agreement Form for the Procurement of Goods (Revised)

*[Not required to be submitted with the Bid, but it shall be submitted within ten (10) days after receiving the
Notice of Award]*

CONTRACT AGREEMENT

THIS AGREEMENT made the _____ day of _____ 20____ between [name of
PROCURING ENTITY] of the Philippines (hereinafter called “the Entity”) of the one part
and [name of Supplier] of [city and country of Supplier] (hereinafter called “the Supplier”) of
the other part;

WHEREAS, the Entity invited Bids for certain goods and ancillary services,
particularly [brief description of goods and services] and has accepted a Bid by the Supplier
for the supply of those goods and services in the sum of *[contract price in words and figures
in specified currency]* (hereinafter called “the Contract Price”).

NOW THIS AGREEMENT WITNESSETH AS FOLLOWS:

1. In this Agreement words and expressions shall have the same meanings as are
respectively assigned to them in the Conditions of Contract referred to.
2. The following documents as required by the 2016 revised Implementing Rules
and Regulations of Republic Act No. 9184 shall be deemed to form and be read
and construed as integral part of this Agreement, *viz.*:
 - i. Philippine Bidding Documents (PBDs);
 - i. Schedule of Requirements;
 - ii. Technical Specifications;
 - iii. General and Special Conditions of Contract; and
 - iv. Supplemental or Bid Bulletins, if any
 - ii. Winning bidder’s bid, including the Eligibility requirements, Technical
and Financial Proposals, and all other documents or statements submitted;

Bid form, including all the documents/statements contained in the Bidder’s
bidding envelopes, as annexes, and all other documents submitted (*e.g.*,
Bidder’s response to request for clarifications on the bid), including
corrections to the bid, if any, resulting from the Procuring Entity’s bid
evaluation;
 - iii. Performance Security;
 - iv. Notice of Award of Contract; and the Bidder’s conforme thereto; and
 - v. Other contract documents that may be required by existing laws and/or the
Procuring Entity concerned in the PBDs. **Winning bidder agrees that
additional contract documents or information prescribed by the
GPPB that are subsequently required for submission after the**

**Supply, Delivery and Installation of Anchor Chains and
it's Associated Components Intended for Ten (10) MRRVs**

**contract execution, such as the Notice to Proceed, Variation Orders,
and Warranty Security, shall likewise form part of the Contract.**

3. In consideration for the sum of *[total contract price in words and figures]* or such other sums as may be ascertained, *[Named of the bidder]* agrees to *[state the object of the contract]* in accordance with his/her/its Bid.
4. The *[Name of the procuring entity]* agrees to pay the above-mentioned sum in accordance with the terms of the Bidding.

IN WITNESS whereof the parties hereto have caused this Agreement to be executed in accordance with the laws of the Republic of the Philippines on the day and year first above written.

[Insert Name and Signature]

[Insert Name and Signature]

[Insert Signatory's Legal Capacity]

[Insert Signatory's Legal Capacity]

for:

for:

[Insert Procuring Entity]

[Insert Name of Supplier]

**Supply, Delivery and Installation of Anchor Chains and
it's Associated Components Intended for Ten (10) MRRVs**

ACKNOWLEDGEMENT

REPUBLIC OF THE PHILIPPINES)
_____) S.S.

BEFORE ME, a Notary Public for and in City of _____, Philippines, this
_____ day of _____, 20____, personally appeared:

NAME

ID ISSUED AT/ON

known to me and known to be the same person who execute the foregoing instrument consisting of _____ (__) pages, including the page whereon the acknowledgments is written and acknowledged before me that the same is his/her free and voluntary act and deed and that of the Corporation/Sole Proprietorship he/she represents.

WITNESS MY HAND AND NOTARIAL SEAL, at the place and on the date first above written.

Doc No. _____;
Page No. _____;
Book No. _____;
Series of 20____.

**Supply, Delivery and Installation of Anchor Chains and
it's Associated Components Intended for Ten (10) MRRVs**

Omnibus Sworn Statement

REPUBLIC OF THE PHILIPPINES)
CITY/MUNICIPALITY OF _____) S.S.

AFFIDAVIT

I, *[Name of Affiant]*, of legal age, *[Civil Status]*, *[Nationality]*, and residing at *[Address of Affiant]*, after having been duly sworn in accordance with law, do hereby depose and state that:

1. *Select one, delete the other:*

If a sole proprietorship: I am the sole proprietor or authorized representative of *[Name of Bidder]* with office address at *[address of Bidder]*;

If a partnership, corporation, cooperative, or joint venture: I am the duly authorized and designated representative of *[Name of Bidder]* with office address at *[address of Bidder]*;

2. *Select one, delete the other:*

If a sole proprietorship: As the owner and sole proprietor, or authorized representative of *[Name of Bidder]*, I have full power and authority to do, execute and perform any and all acts necessary to participate, submit the bid, and to sign and execute the ensuing contract for *[Name of the Project]* of the *[Name of the Procuring Entity]*, as shown in the attached duly notarized *Special Power of Attorney*;

If a partnership, corporation, cooperative, or joint venture: I am granted full power and authority to do, execute and perform any and all acts necessary to participate, submit the bid, and to sign and execute the ensuing contract for *[Name of the Project]* of the *[Name of the Procuring Entity]*, as shown in the attached *[state title of attached document showing proof of authorization (e.g., duly notarized Secretary's Certificate, Board/Partnership Resolution, or Special Power of Attorney, whichever is applicable);]*;

3. *[Name of Bidder]* is not "blacklisted" or barred from bidding by the Government of the Philippines or any of its agencies, offices, corporations, or Local Government Units, foreign government/foreign or international financing institution whose blacklisting rules have been recognized by the Government Procurement Policy Board, **by itself or by relation, membership, association, affiliation, or controlling interest with another blacklisted person or entity as defined and provided for in the Uniform Guidelines on Blacklisting;**

4. Each of the documents submitted in satisfaction of the bidding requirements is an authentic copy of the original, complete, and all statements and information provided therein are true and correct;

**Supply, Delivery and Installation of Anchor Chains and
it's Associated Components Intended for Ten (10) MRRVs**

5. *[Name of Bidder]* is authorizing the Head of the Procuring Entity or its duly authorized representative(s) to verify all the documents submitted;

6. ***Select one, delete the rest:***

If a sole proprietorship: The owner or sole proprietor is not related to the Head of the Procuring Entity, members of the Bids and Awards Committee (BAC), the Technical Working Group, and the BAC Secretariat, the head of the Project Management Office or the end-user unit, and the project consultants by consanguinity or affinity up to the third civil degree;

If a partnership or cooperative: None of the officers and members of *[Name of Bidder]* is related to the Head of the Procuring Entity, members of the Bids and Awards Committee (BAC), the Technical Working Group, and the BAC Secretariat, the head of the Project Management Office or the end-user unit, and the project consultants by consanguinity or affinity up to the third civil degree;

If a corporation or joint venture: None of the officers, directors, and controlling stockholders of *[Name of Bidder]* is related to the Head of the Procuring Entity, members of the Bids and Awards Committee (BAC), the Technical Working Group, and the BAC Secretariat, the head of the Project Management Office or the end-user unit, and the project consultants by consanguinity or affinity up to the third civil degree;

7. *[Name of Bidder]* complies with existing labor laws and standards; and
8. *[Name of Bidder]* is aware of and has undertaken the following responsibilities as a Bidder:
- a) Carefully examine all of the Bidding Documents;
 - b) Acknowledge all conditions, local or otherwise, affecting the implementation of the Contract;
 - c) Made an estimate of the facilities available and needed for the contract to be bid, if any; and
 - d) Inquire or secure Supplemental/Bid Bulletin(s) issued for the *[Name of the Project]*.
9. *[Name of Bidder]* did not give or pay directly or indirectly, any commission, amount, fee, or any form of consideration, pecuniary or otherwise, to any person or official, personnel or representative of the government in relation to any procurement project or activity.
10. In case advance payment was made or given, failure to perform or deliver any of the obligations and undertakings in the contract shall be sufficient grounds to constitute criminal liability for Swindling (Estafa) or the commission of fraud with unfaithfulness or abuse of confidence through misappropriating or converting any

**Supply, Delivery and Installation of Anchor Chains and
it's Associated Components Intended for Ten (10) MRRVs**

payment received by a person or entity under an obligation involving the duty to deliver certain goods or services, to the prejudice of the public and the government of the Philippines pursuant to Article 315 of Act No. 3815 s. 1930, as amended, or the Revised Penal Code.

IN WITNESS WHEREOF, I have hereunto set my hand this ____ day of ____, 20__ at _____, Philippines.

Bidder's Representative/Authorized Signatory

SUBSCRIBED AND SWORN to before me this ____ day of [month] [year] at [place of execution], Philippines. Affiant/s is/are personally known to me and was/were identified by me through competent evidence of identity as defined in the 2004 Rules on Notarial Practice (A.M. No. 02-8-13-SC). Affiant/s exhibited to me his/her [insert type of government identification card used], with his/her photograph and signature appearing thereon with no. _____ issued on ____ at _____.

Witness my hand and seal this ____ day of [month] [year].

NAME OF NOTARY PUBLIC

Serial No. of Commission _____

Notary Public for _____ until _____

Roll of Attorneys No. _____

PTR No. _____ [date issued], [place issued]

IBP No. _____ [date issued], [place issued]

Doc. No. _____

Page No. _____

Book No. _____

Series of _____

**Supply, Delivery and Installation of Anchor Chains and
it's Associated Components Intended for Ten (10) MRRVs**

BID SECURING DECLARATION FORM

REPUBLIC OF THE PHILIPPINES)
CITY OF _____) S.S.

BID SECURING DECLARATION
Project Identification No.: [Insert number]

To: *[Insert name and address of the Procuring Entity]*

I/We, the undersigned, declare that:

1. I/We understand that, according to your conditions, bids must be supported by a Bid Security, which may be in the form of a Bid Securing Declaration.
2. I/We accept that: (a) I/we will be automatically disqualified from bidding for any procurement contract with any procuring entity for a period of two (2) years upon receipt of your Blacklisting Order; and, (b) I/we will pay the applicable fine provided under Section 6 of the Guidelines on the Use of Bid Securing Declaration, within fifteen (15) days from receipt of the written demand by the procuring entity for the commission of acts resulting to the enforcement of the bid securing declaration under Sections 23.1(b), 34.2, 40.1 and 69.1, except 69.1(f), of the IRR of RA No. 9184; without prejudice to other legal action the government may undertake.
3. I/We understand that this Bid Securing Declaration shall cease to be valid on the following circumstances:
 - a. Upon expiration of the bid validity period, or any extension thereof pursuant to your request;
 - b. I am/we are declared ineligible or post-disqualified upon receipt of your notice to such effect, and (i) I/we failed to timely file a request for reconsideration or (ii) I/we filed a waiver to avail of said right; and
 - c. I am/we are declared the bidder with the Lowest Calculated Responsive Bid, and I/we have furnished the performance security and signed the Contract.

IN WITNESS WHEREOF, I/We have hereunto set my/our hand/s this ____ day of [month]
[year] at [place of execution].

*[Insert NAME OF BIDDER OR ITS AUTHORIZED
REPRESENTATIVE]
[Insert signatory's legal capacity]
Affiant*

**Supply, Delivery and Installation of Anchor Chains and
it's Associated Components Intended for Ten (10) MRRVs**

SUBSCRIBED AND SWORN to before me this ____ day of *[month]* *[year]* at *[place of execution]*, Philippines. Affiant/s is/are personally known to me and was/were identified by me through competent evidence of identity as defined in the 2004 Rules on Notarial Practice (A.M. No. 02-8-13-SC). Affiant/s exhibited to me his/her *[insert type of government identification card used]*, with his/her photograph and signature appearing thereon, with no. _____ issued on ____ at _____.

Witness my hand and seal this ____ day of *[month]* *[year]*.

NAME OF NOTARY PUBLIC

Serial No. of Commission _____

Notary Public for _____ until _____

Roll of Attorneys No. _____

PTR No. _____ *[date issued]*, *[place issued]*

IBP No. _____ *[date issued]*, *[place issued]*

Doc. No. _____

Page No. _____

Book No. _____

Series of _____

**Supply, Delivery and Installation of Anchor Chains and
it's Associated Components Intended for Ten (10) MRRVs**

STATEMENT OF ALL ON-GOING GOVERNMENT AND PRIVATE CONTRACTS

Kindly supply the required information in the spaces provided.

Name of Bidder _____. Invitation to Bid Number __. Page . of ____.

Name of the Contract	Date of the Contract	Contract Duration	Owner's Name and Address	Contact Person and Contact Details (Tel./Cell No. and/or Email Address)	Kinds of Goods	Date of Delivery (Please indicate estimated date of delivery)	Amount of Contract	Value of Outstanding Contracts
Government Contracts:								
Private Contracts:								
Total								

[Signature of the Authorized Rep.]

[in the capacity of] (Please indicate position of Authorized Rep.)]

Duly authorized to sign Bid for and on behalf of _____
(Please indicate name of company)

NOTE:

The aforesaid statement should include those contracts awarded but not yet started.

Further, bidders should indicate "None" or "No On-going Government and/or Private Contracts" if they do not have any on-ongoing government and/or private contracts in the corresponding rows and/or column, including contracts awarded but not yet started, whether similar or not similar in nature and complexity to the contract to be bid.

**Supply, Delivery and Installation of Anchor Chains and
it's Associated Components Intended for Ten (10) MRRVs**

STATEMENT OF THE SINGLE LARGEST COMPLETED CONTRACT

Kindly supply the required information in the spaces provided.

Name of Bidder _____. Invitation to Bid Number __. Page of ____.

Name of the Contract	Date of the Contract	Contract Duration	Owner's Name and Address	Contact Person and Contact Details (Tel./Cell No. and/or Email Address)	Kinds of Goods	Amount of Contract adjusted by the bidder to current prices using PSA's consumer price index, if necessary for purposes of meeting the SLCC requirement;	Date of Delivery (Please indicate actual date of delivery)

[Signature of the Authorized Rep.]

[in the capacity of] (Please indicate position of Authorized Rep.)]

Duly authorized to sign Bid for and on behalf of _____
(Please indicate name of company)

NOTE:

Bidders shall submit and attach a copy of the end-user's acceptance or official receipt(s) or sales invoice.

**Supply, Delivery and Installation of Anchor Chains and
it's Associated Components Intended for Ten (10) MRRVs**

NFCC COMPUTATION

Kindly supply the required information in the spaces provided.

Name of Bidder _____. Invitation to Bid Number __. Page . of ____.

ABC	PhP7,816, 173.33
DETAILS	AMOUNT
Current Assets	
Minus	
Current Liabilities	
Difference of Current Assets and Current Liabilities	
Multiplied by	
K	15
Total (Product)	
Minus	
Total value of all outstanding contracts, including those awarded but not yet started	
Total NFCC Computation	

[Signature of the Authorized Rep.] [in the capacity of] (Please indicate position
of Authorized Rep.)]

Duly authorized to sign Bid for and on behalf of _____
(Please indicate name of company)

**Supply, Delivery and Installation of Anchor Chains and
it's Associated Components Intended for Ten (10) MRRVs**

REPUBLIC OF THE PHILIPPINES)
CITY OF _____) S.S.

X-----X

PERFORMANCE SECURING DECLARATION

Invitation to Bid: [Insert Reference Number indicated in the Bidding Documents]

To: [Insert name and address of the Procuring Entity]

I/We, the undersigned, declare that:

1. I/We understand that, according to your conditions, to guarantee the faithful performance by the supplier/distributor/manufacturer/ contractor/consultant of its obligations under the Contract, I/we shall submit a Performance Securing Declaration within a maximum period of ten (10) calendar days from the receipt of the Notice of Award prior to the signing of the Contract.
2. I/We accept that: I/we will be automatically disqualified from bidding for any procurement contract with any procuring entity for a period of one (1) year if in case it is my first offense, or two (2) years if I have a prior similar offense upon receipt of your Blacklisting Order if I/we have violated my/our obligations under the Contract.
3. I/We understand that this Performance Securing Declaration shall cease to be valid upon:
 - a. issuance by the Procuring Entity of the Certificate of Final Acceptance, subject to the following conditions:
 - i. Procuring Entity has no claims filed against the contract awardee;
 - ii. It has no claims for labor and materials filed against the contractor; and
 - iii. Other terms of the contract; or
 - b. replacement by the winning bidder of the submitted PSD with a performance security in any of the prescribed forms under Section 39.2 of the 2016 IRR of RA No. 9184 as required by the end-user.

IN WITNESS WHEREOF, I/We have hereunto set my/our hand/s this ____ day of [month] [year] at [place of execution].

*[Insert NAME OF BIDDER'S AUTHORIZED
REPRESENTATIVE]
[Insert Signatory's Legal Capacity]*

**Supply, Delivery and Installation of Anchor Chains and
it's Associated Components Intended for Ten (10) MRRVs**

Affiant

SUBSCRIBED AND SWORN to before me this ____ day of *[month]* *[year]* at *[place of execution]*, Philippines. Affiant/s is/are personally known to me and was/were identified by me through competent evidence of identity as defined in the 2004 Rules on Notarial Practice (A.M. No. 02-8-13-SC). Affiant/s exhibited to me his/her [insert type of government identification card used], with his/her photograph and signature appearing thereon, with no. _____ issued on ____ at _____.

Witness my hand and seal this ____ day of *[month]* *[year]*.

NAME OF NOTARY PUBLIC

Serial No. of Commission _____

Notary Public for _____ until _____

Roll of Attorneys No. _____

PTR No. _____ *[date issued]*, *[place issued]*

IBP No. _____ *[date issued]*, *[place issued]*

Doc. No. _____

Page No. _____

Book No. _____

Series of _____

DIAGRAM FOR THE SEALING AND MARKING OF THE BID ENVELOPES

